



## -Single End-

#3  
No. 01003



## -Ball Point-

#1  
No. 01221

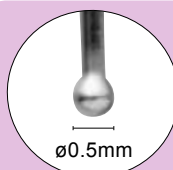

\*The round tip realizes checking of caries without damaging pit and fissure tissues.

\*Suitable for filling of sealant.



# Excavator



## -Round Tip Type-2-



Str. #1 / Cvd. #1



Str. #2 / Cvd. #2



Str. #3 / Cvd. #3



Str. #4L / Cvd. #4L

\*The minimum spoon is effective for micro cavity preparation.



\*The long shank is designed so it doesn't obstruct the view under microscope.

\*The reason why "spoon excavator" doesn't have the risk of excessive excavation.

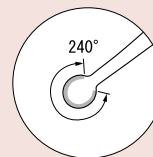
\*Material / Si (Color Ring)



\*The edge along with the circle at a tip remove softened dentin and make cavity preparation efficiently.

Description		#1	#2	#3	#4L
Str.	 Cavity preparation for wall and floor.	01605	01606	01607	01608
Cvd.	 Used for undercut area, narrow rim of an opening and at the cavity angle.	01705	01706	01707	01708





# Excavator

Autoclavable  
up to **135°C**  
OK

## -CDR Type-2-

\*Excavator which pursued minimal intervention.



\*Material / Si (Color Ring)

Point **1**

**Efficient**

#1 • #2

300°

300° wide edge allows efficiently removal of cavity dentine.

Point **2**

**Sanitary**

#1 • #2

Pear Shaped

Slope working part design allows easy clean of particles.

Point **3**

**Complete removal**

#3

Dentin

Cavity

Dental enamel

Breakage

Dentin

Cavity

Dental enamel

Carious dentin which is contiguous to dental enamel can be removed without breaking the dental enamel.



# Mouth Prop



## -with Tongue Guard-

**Contents** Mouth Prop / Tongue Guard Right, Left

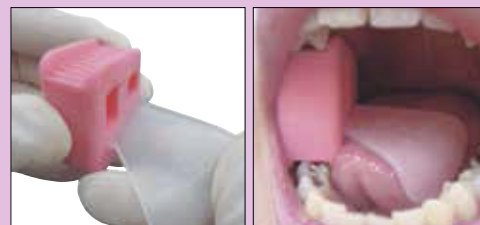
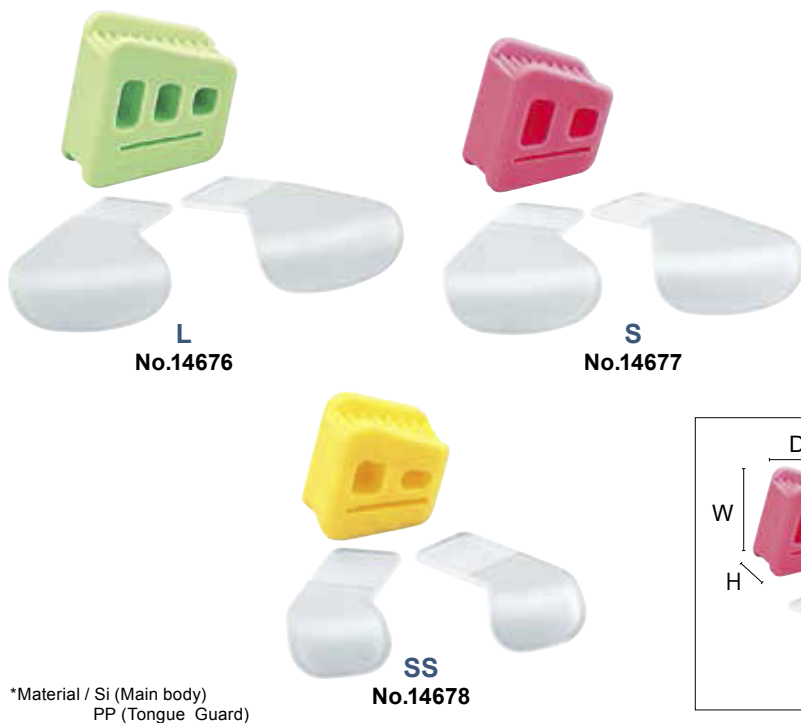

\*Prop the mouth open and depress the tongue simultaneously.

Description		Size (mm)		
		W	D	H
Mouth Prop	L	40	35	17
	S	35	29	16
	SS	30	25	16
Tongue Guard	L / S	52	34	-
	SS	39	24	-



# Almighty Mouth Gag



**Contents** Main body, Tip (4 ea.)



\*Bite pressure / up to 1400N  
\*Material / Si (Tip)



# Mouth Mirror (Simple Stem)



## -Clear 2-

\*With thin glass, there is little blur of an image and reflected vividly.

\*Suitable only for YDM mirror handle.



**3P**  
**No. 13071**

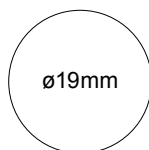

**4P**  
**No. 13073**

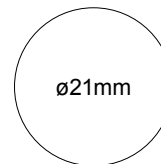

\*Thickness / 1.9mm

\*Reflection rate / About 93%

## -Front Surface-

### \*Titanium Coating

\*Direct reflection prevents an image blurring.

\*Suitable only for YDM mirror handle.

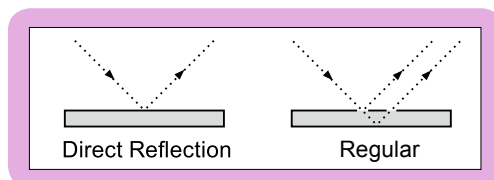

**3P**  
**No. 13077**

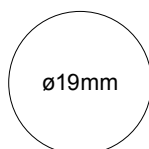

**4P**  
**No. 13079**

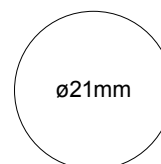

\*Thickness / 1.9mm

\*Reflection rate / About 98%



# Metal Mirror (Simple Stem)



\*The mirror made from stainless steel does not have a fear of being divided, and is suitable for the medical treatment of child dentistry, disabled person dentistry.

\*Suitable only for YDM mirror handle.

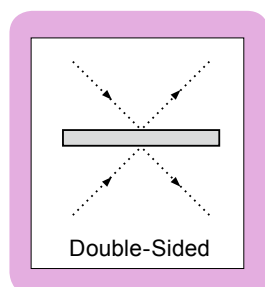

**No. 13131**

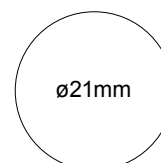

\*Thickness / 1.1mm

\*Reflection rate / About 65%



# Mirror Handle



\*Suitable only for YDM mouth mirror.



**Octagonal**  
**No. 13121**



# Mirror Handle with Millimeter Scale



\*Suitable only for YDM mouth mirror.



**Green**  
**No.13118**



**Blue**  
**No.13119**



**Pink**  
**No.13120**

\*Material / POM

[How to measure endodontic file or reamer.]



① Fit stopper of reamer or file and pull in the direction of arrow.

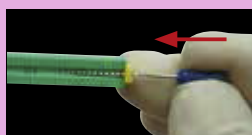

② Measure the length of reamer or file with scale on the handle.



③ Stopper of reamer or file is fixed.

\*Measurement: Up to 30mm



**Adult**  
**No. 08101**

Size / W98 x D90mm



**Child**  
**No. 08102**

Size / W89 x D70mm



# Rubber Dam Punch Type-2



No. 08111

Hole diameter /  $\phi 0.75\text{mm}$   
 $\phi 1.00\text{mm}$   
 $\phi 1.50\text{mm}$   
 $\phi 1.70\text{mm}$   
 $\phi 2.00\text{mm}$

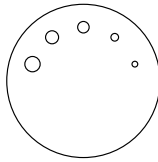

\*Size / 165mm



## Clamp Forceps

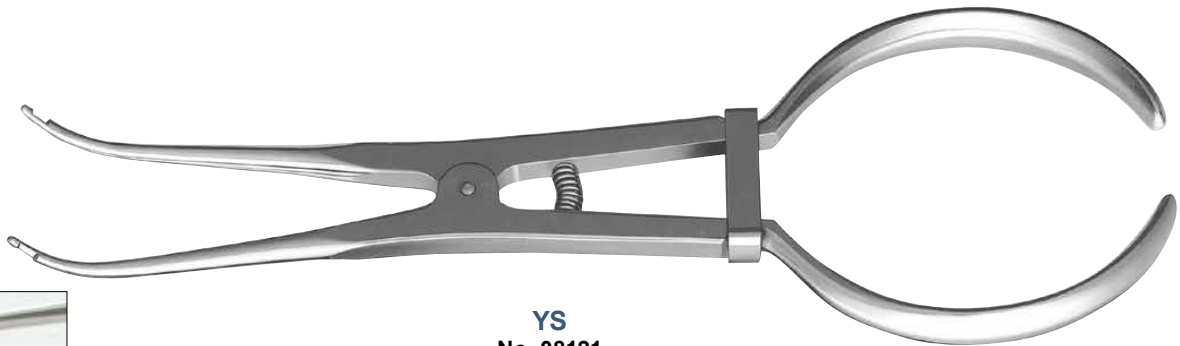

YS  
No. 08121

\*Size / 175mm

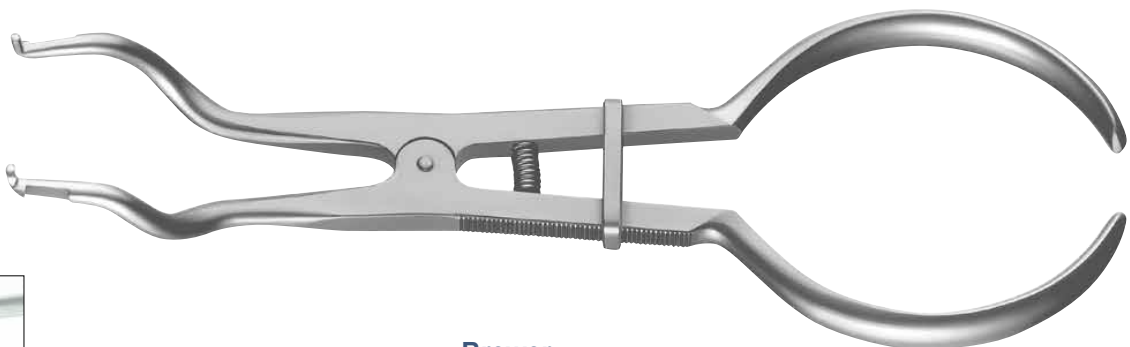

Brewer  
No. 08120

\*Size / 165mm





# Rubber Dam Clamp



## \*Stainless Steel

\*#12A / 13A → Serrated jaws and offset jaw height provides stability to partially erupted teeth.

\*#26 / #26A → Used in pedodontic. In that case, #26 is for deciduous molars and #26A is for deciduous anterior teeth.



#210



#211



#DR



#DL



#206



#207



#26A



#12A



#13A



#201



#26



#202



#56

### -Clamp shape-



Fit on gingival margin.  
(Grasp part curves downward)



Gum is not pressed.  
(Grasp part is flat)

No.		Description	Shape
08526	#26	Upper molars	A
08501	#201	Upper molars	A
08556	#56	Lower molars	A
08502	#202	Lower molars	B
08506	#206	Premolars	A
08507	#207	Premolars	B
08527	#26A	Premolars	B

No.		Description	Shape
08510	#210	Anterior teeth	B
08511	#211	Anterior teeth	B
08560	#DR	Lower first deciduous molar right	A
08561	#DL	Lower first deciduous molar left	A
08512	#12A	Lower molars / Wisdom teeth	B
08513	#13A	Lower molars / Wisdom teeth	B

## Board

No. 08258



### - How to use -



Size / W132 x D87mm





# Composite Filling Instrument



## -TMDU 2 (Tokyo Medical Dental University)-

### \*Diamond Like Carbon Coating

\*Remarkably stick-resistant for easy workability. Improved strength, and superior wear resistance.

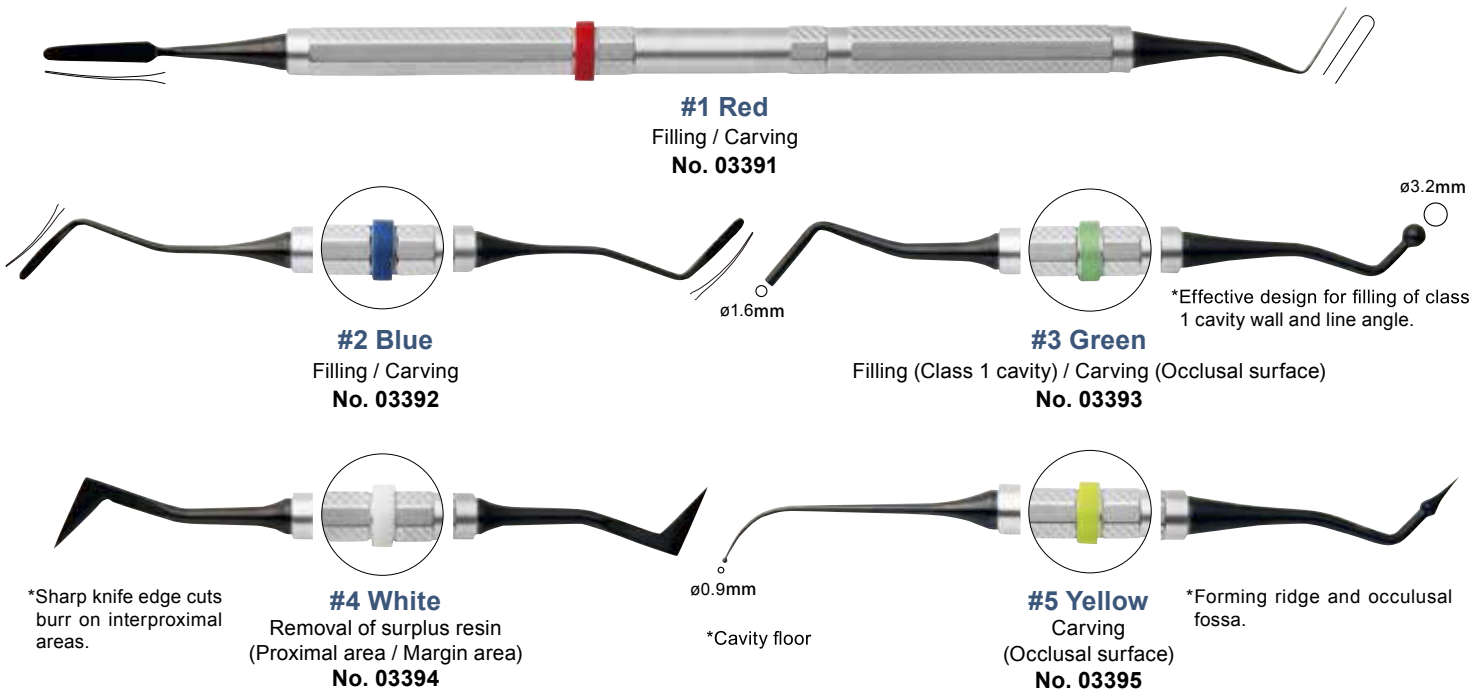

\*Thickness / 0.2mm (#1)  
0.1mm (#2)

\*Material / Si (Color Ring)



[ Anterior labial side ]  
Inside curved part is for cervical area and outside one is for incisal area.

**#1 Red**

[ Contact surface of tooth ]  
Excellent thin tip allows approach narrow proximal area.



[ Premolar labial side ]  
Curved neck part allows it easy to approach over lip.

**#2 Blue**

[ Molar occlusal side ]  
For pit and fissure.



[ Molar occlusal side / Anterior lingual side ]  
For Class I cavity, fill cavity wall and cavity floor without bubble.

**#3 Green**

[ Molar occlusal side ]  
Adjust shape after filling. Efficient for lingual side of upper central incisal too.



[Margin]  
Remove with scraping surplus resin after cured.

**#4 White**



[Molar occlusal side]  
Form occlusal ridge.

**#5 Yellow**

[Molar occlusal side]  
Make pit part.





# Composite Filling Instrument



## -TMDU 3 (Tokyo Medical Dental University)-

### \*Diamond Like Carbon Coating

\*Remarkably stick-resistant for easy workability. Improved strength, and superior wear resistance.



**#1 Blue**  
Filling / Carving  
**No. 03341**

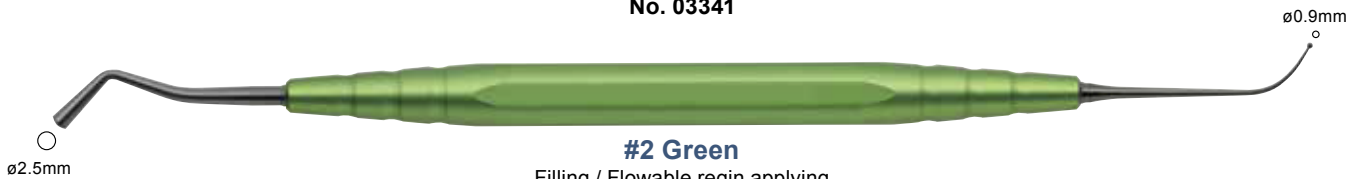

**#2 Green**  
Filling / Flowable resin applying  
**No. 03342**



**#3 Red**  
Filling / Carving  
**No. 03343**



**#4 Silver**  
Removal of surplus resin  
(Proximal area / Margin area)  
**No. 03344**

\*Thickness / 0.1mm (#1 & #3 Left)  
0.2mm (#3 Right)

\*Sharp knife edge cuts  
burr on interproximal  
areas.



[ Molar and Carrying resin ]  
Fill molar part and adjust shape  
of resin, carry resin.

**#1  
Blue**

[Molar occlusal side /  
Anterior lingual side]  
Fill cavity wall and cavity floor  
without bubble.



[Anterior labial side]  
Inside curved part is for cervical  
area and outside one is for  
incisal area.

**#3  
Red**

[ Far end of last molar ]  
Excellent angle for  
approaching, filling distal end  
of the last molar.



[ Molar occlusal side /  
Anterior lingual side ]  
Fill big pit.

**#2  
Green**

[ Cavity Floor /  
Molar occlusal side ]  
Fill flowable resin into tiny cavity.  
Form occlusal ridge.



[Margins]  
Remove with scraping surplus  
resin after cured.

**#4  
Silver**



# Reamer Guard



\*Can be arranged "Reamer Guard" by reamer or file type and size.

\*Cover will not allow the reamers and files to fall out.

\*An Engine reamer can be stored with "Bur Guard".

No.	Description
08431	Yellow
08432	Orange
08433	Pink
08434	Blue
08435	Green



-Holding length-



\*Storage capacity / 8 reamers and files

\*Size / W74 x D10 x H52 mm

\*Material / POM

\*Sterilizable with liquid sterilizing solutions.

\*Product does not include reamers and files.

**Sold Separately**

**Case**

**No. 08439**



\*Storage capacity / 18 ea.

\*Size / W167 x D126 x H62mm

\*Sterilizable with liquid sterilizing solutions.

\*Product does not include "Reamer Guard".

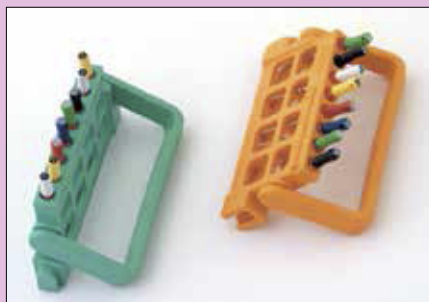

\*The cover becomes a stand.

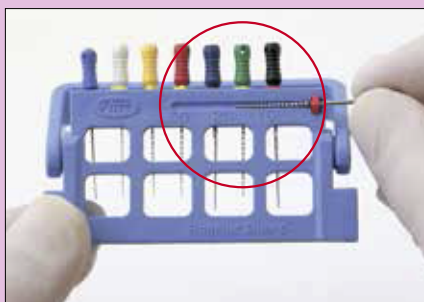

\*Has a built in gauge to measure stop positions during root canal treatments.



\*Able to connect each "Reamer Guards".

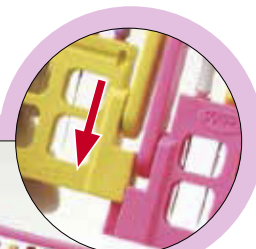



# Bur Guard



\*Color-coded design allows organization of burs according to their type, treatment method, length, etc.

\*The cover will not allow burs to fall out.

\*Also used for storage for engine reamers.

No.	Description
13471	Yellow
13472	Orange
13473	Pink
13474	Blue
13475	Green



\*Storage Capacity / 12 burs.

\*Holding length / from 17 to 37mm

(When using the long cover / from 32 to 52 mm)

\*Size / W69 x D10 x H41.5 to 56.5mm

(When using long cover / W69 x D10 x H55 to 70mm)

\*Material / POM

\*Sterilizable with liquid sterilizing solutions.

\*Product does not include burs.

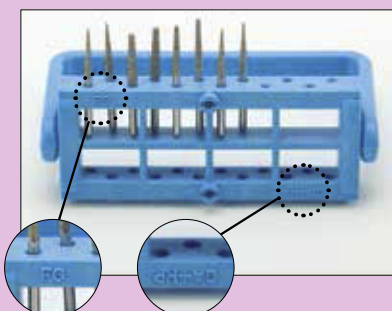

FG

CA / HP

\*The main body is reversible for use in either FG burs or CA / HP burs.



\*The height can be adjusted to three levels.



\*Each "Bur Guard" can be connected.

## Sold Separately

### Long Cover



No.	Description
13481	Yellow
13482	Orange
13483	Pink
13484	Blue
13485	Green



Long Cover

Regular

\*Also able to hold laboratory hand piece burs when using the long cover.

### Case

No. 08439



\*Storage Capacity / 18 ea.

\*Size / W167 x D126 x H62mm

\*Sterilizable with liquid sterilizing solutions.

\*Product does not include "Bur Guard".



# Cheek Retractor

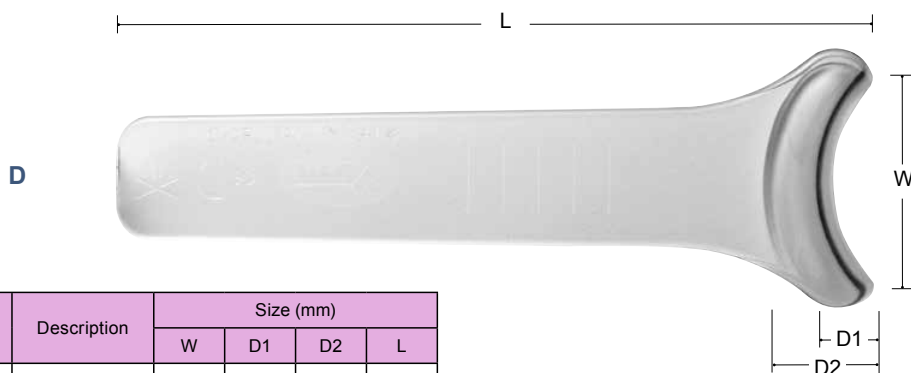
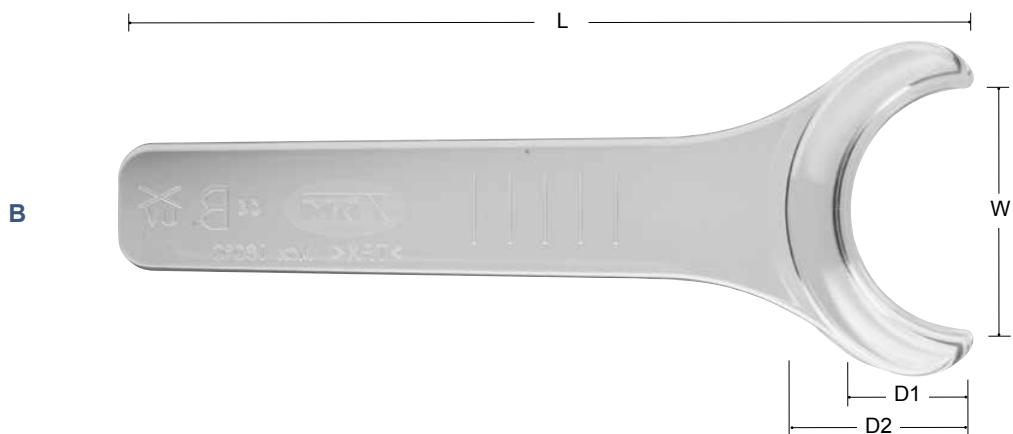
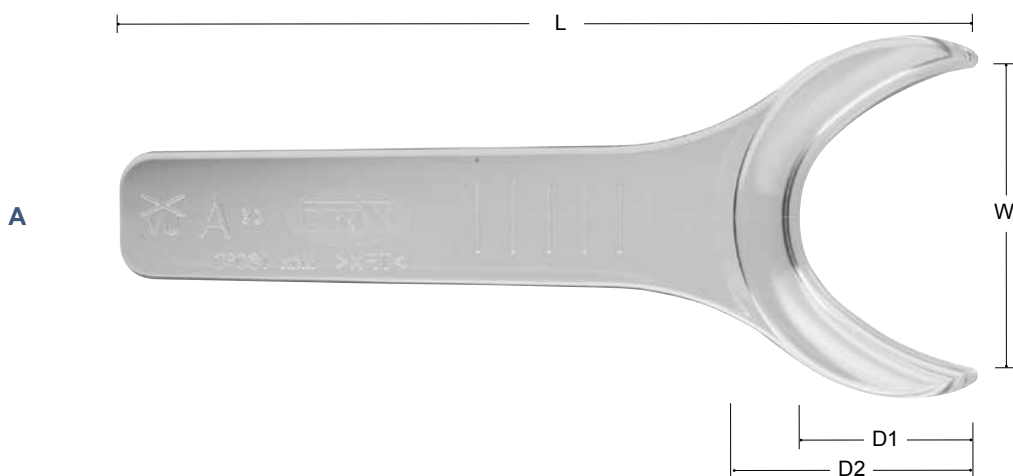

No.	Description	Size (mm)			
		W	D1	D2	L
22731	A (2 ea.)	42	25	35	120
22732	B (2 ea.)	34	17	27	120
22733	C (2 ea.)	15	-	-	74.3
22734	D (2 ea.)	28	6	16	108

\*Material / TPX

\*In the case of occlusal photography, possibly used as lip retractor. With photographic mirror occlusal.



# Cheek Retractor



## -Pigeon-

\*Easily holding by patient.

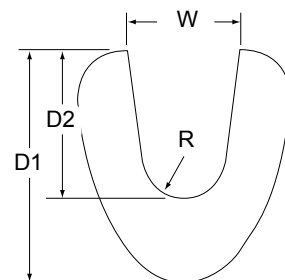

\*Material / TPX

No.	Description	Size (mm)			
		W	D1	D2	R
22739	Pigeon M	30	50	32	R10
22740	Pigeon S	24	50	32	R9
22741	Pigeon SS	24	43	28	R7

## -Anglewider-

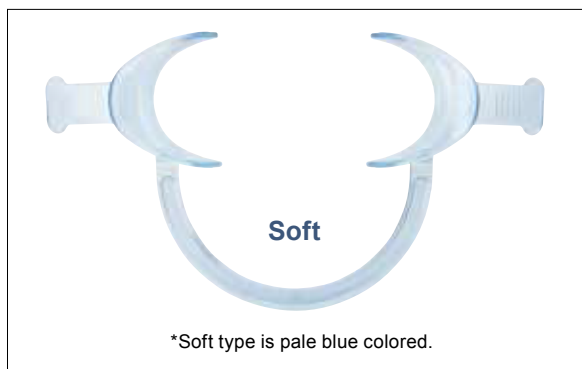
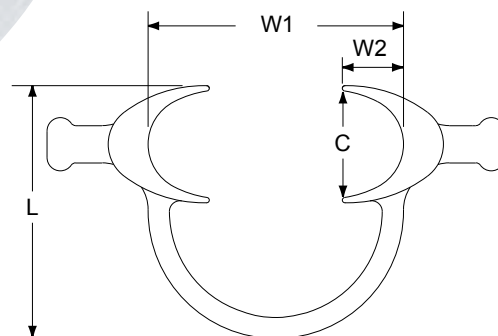

\*Soft type is pale blue colored.

\*Material / TPX

No.	Description	Size (mm)			
		W1	W2	L	C
22745	Anglewider	96	23	95	40
22729	Anglewider Soft				





# Cheek Retractor



## -Anglewider-

- \*It opens corners of the mouth, and allows clear views without auxiliary personnel.
- \*The inner wings retract buccal mucosa, and thereby oral vestibule is clear.

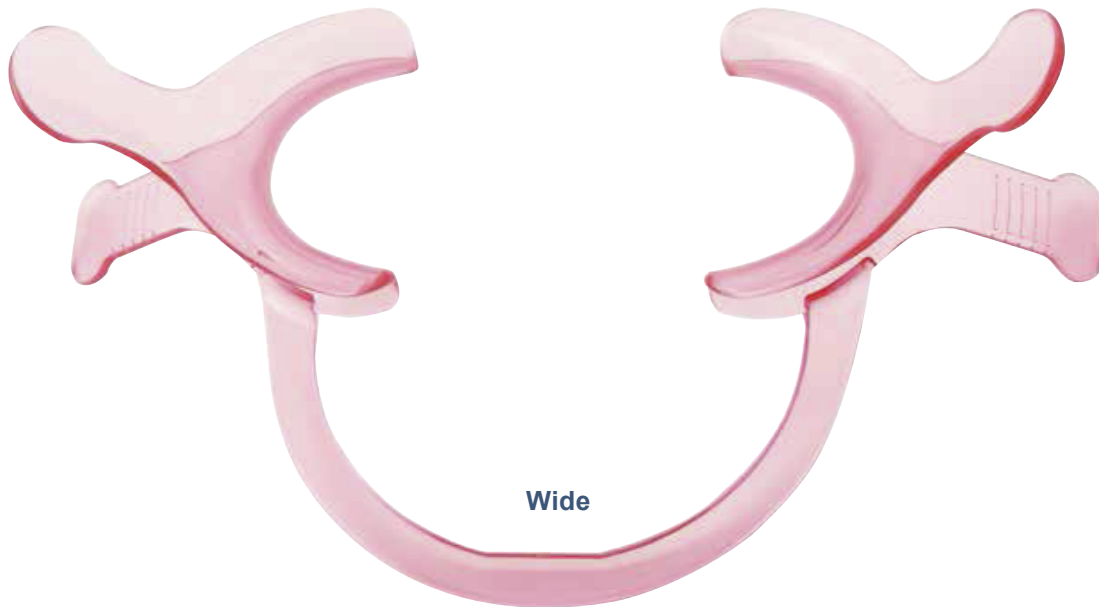

Wide

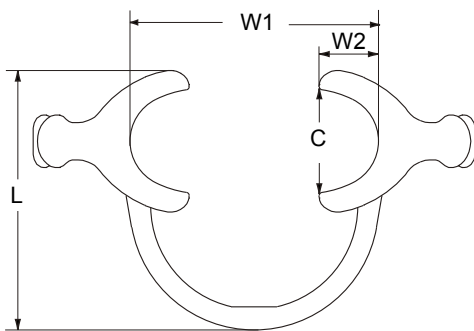

\*Material / TPX

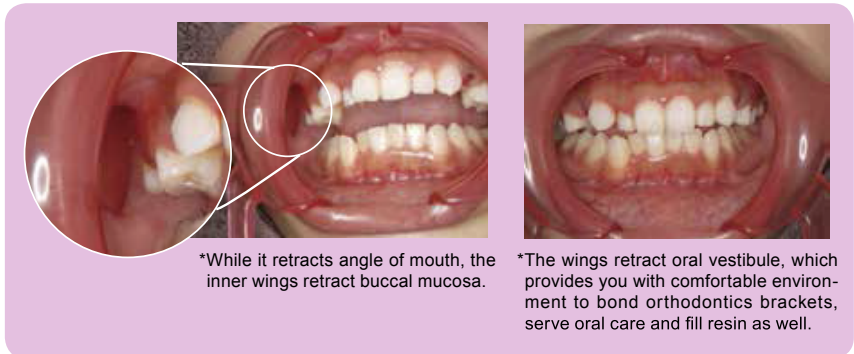

\*While it retracts angle of mouth, the inner wings retract buccal mucosa.

\*The wings retract oral vestibule, which provides you with comfortable environment to bond orthodontics brackets, serve oral care and fill resin as well.

- \*It opens corners of the mouth, and allows clear views without support.
- It is absolutely convenient for taking a photo of mouth, serving oral care, doing orthodontics treatment.
- \*It is in size for infants to lower elementary school kids.

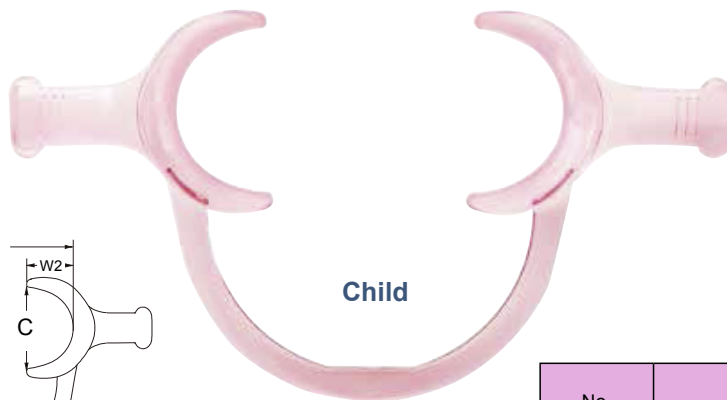

Child

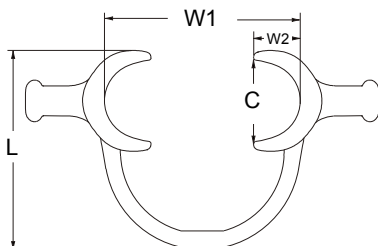

\*Material / TPX

No.	Description	Size (mm)			
		W1	W2	L	C
22727	Anglewider Wide	96	23	100	40
22728	Anglewider for Child	67	16	68	40



# Cheek Retractor



## -Doublewider-

\*Retract cheeks, lips, and tongue for maximum visibility and patient's comfort.

\*Suitable for dental aesthetic instruction, inoffice bleaching and bracket wearing in orthodontic treatment.

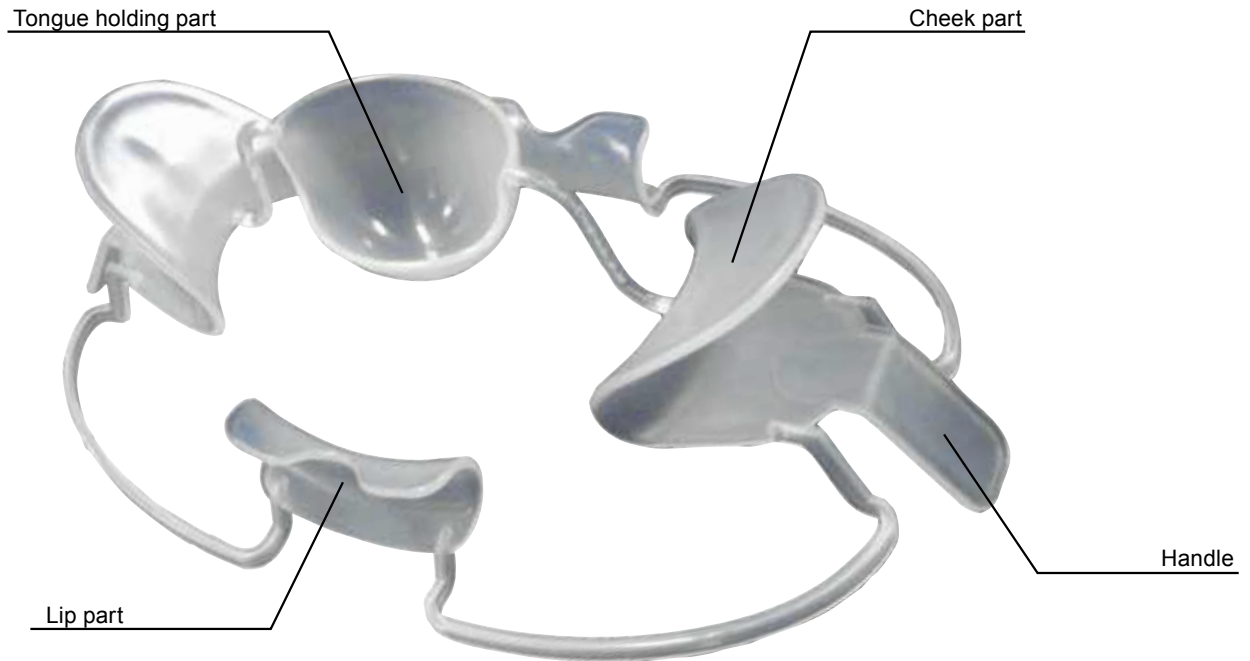

\*Material / PP : Deflection temperature 120°C

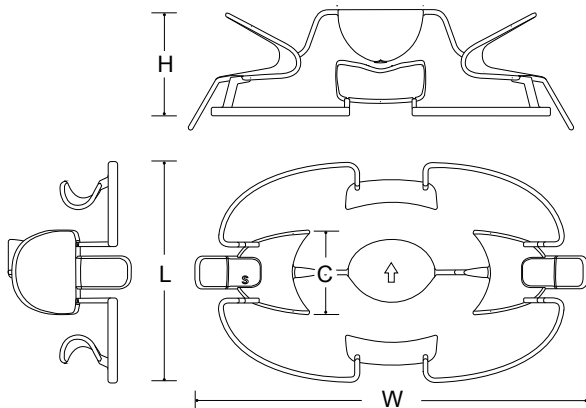

No.	Description	Size (mm)			
		W	L	H	C
22750	Doublewider L	171	96	54.5	38
22749	Doublewider S	161	90	50.5	35
22725	Doublewider SS	157	80	42	25



\*Tongue holding part can be removed if you don't need it.



1) Make sure the up and down by the arrow on the tongue holding part, twist the both handle parts and insert the right and left cheek parts into the mouth.



2) Place the lip parts to the upper and lower lips.





# Photographic Mirror



## -Stainless Steel-

\*Use of stainless steel avoids breakage, allowing long term use of the mirror.

\*Sterilization pouch included.

\*In sterilization, put mirror into pouch without disposal sterilization pack.



\*Bended design for keeping fingers out of your clinical photographs.



\*\*"Occlusal Wide LL" and "Occlusal LL" Mirror is ideal for taking a photograph of "Margin" and "Buccal mucosa" even the patient has wide dental arch.

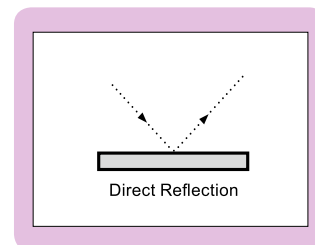

## \*Rodium Coating

(With "Rodium" marking on the back side)

\*Reflection rate / About 85%

No.	Description
13578	Occlusal Wide LL
13576	Occlusal Wide L
13577	Occlusal Wide S
13571	Occlusal
13572	Lingual
13573	Buccal

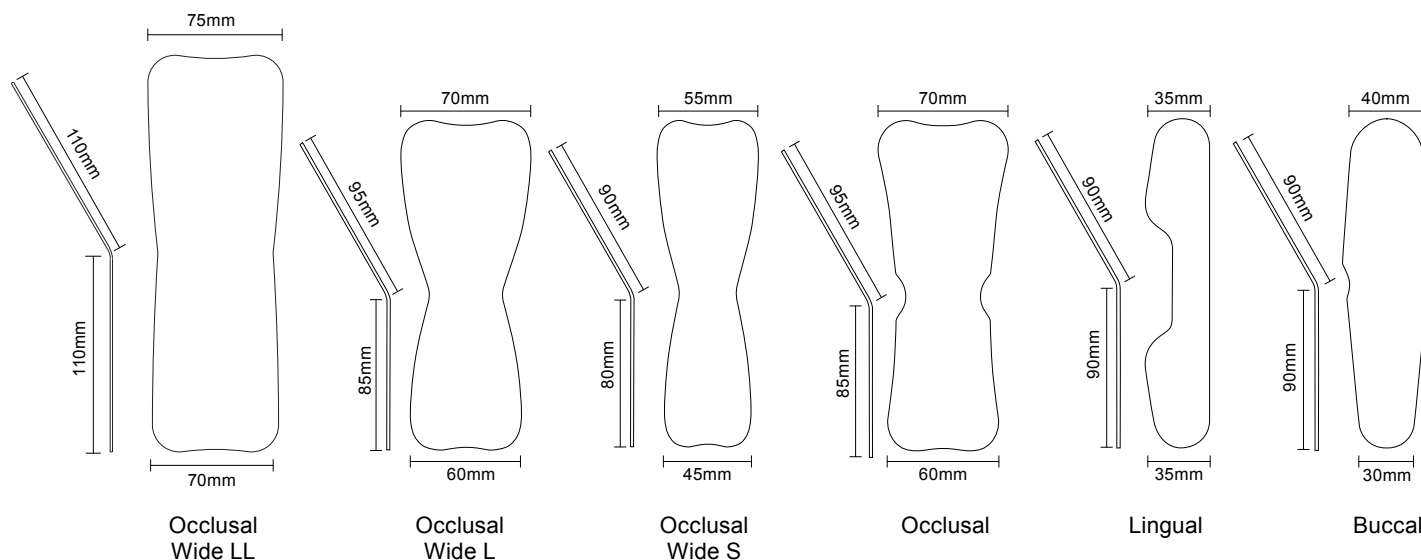





# Photographic Mirror



## Made of "Hard Stainless steel"

\*YDM Photographic Mirrors have more hardness than normal stainless steel.

This feature makes YDM photographic mirrors hardly scratched and distorted.

\*It can be damaged under improper use.

### Hardness Comparison(Vickers Hardness)

[YDM Photographic Mirror]	approx.533HV
Hard Stainless steel + Rhodium coating	
[YDM Photographic Mirror ST]	approx.369HV
Hard Stainless steel	
[Normal Rhodium coated mirror]	approx.240HV
Normal Stainless steel + Rhodium coating	
[Normal Rhodium coated mirror]	approx.198HV
Normal Stainless steel	

## -SE-

\*Without Rodium Coating

\*Economy Type

\*Reflection rate / About 65%



**Occlusal LL**  
No. 13274



**Occlusal L**  
No. 13272



**Occlusal M**  
No. 13273



**Buccal & Lingual**  
No. 13271

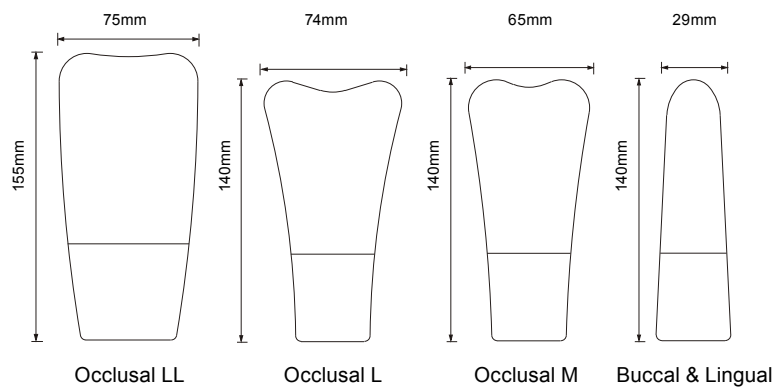



**\*Teflon coated aluminum.**

\*Suitable for checking shade breaching and examining of wedge shaped defects and cervical caries, etc.

\*Designed to fit the shape of dental arch.



**Anterior L**  
**No.13641**



**Anterior S**  
**No.13643**



**Posterior**  
**No.13642**



	With contraster	Without contraster
Upper Anterior		
Lower Posterior		

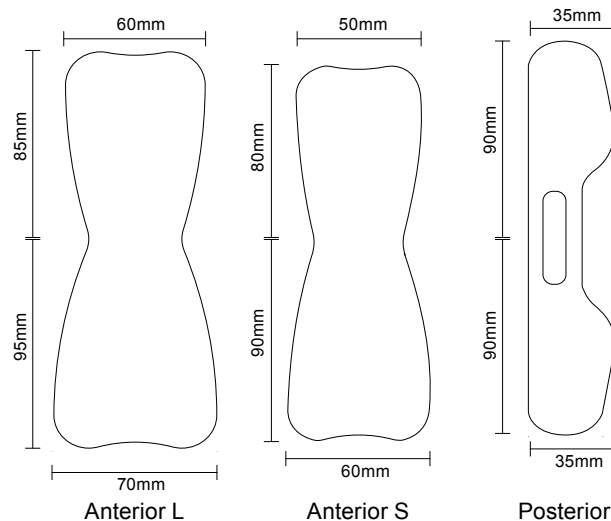



# Color Tray



## -Premium-

### \*Aluminium

\*Color coded for easy identification.

\*By an edge with height, the impression of a frenum or buccal mucous membrane can be taken firmly.

\*Easily bendable for a custom fit.

#### Upper



Pink

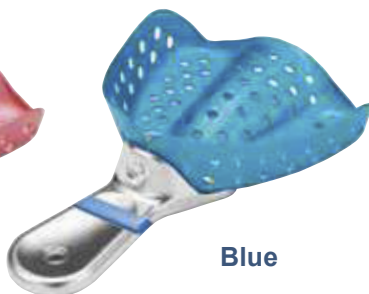

Blue

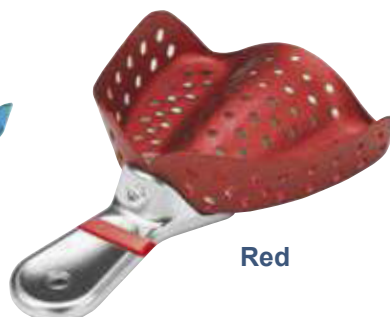

Red



Gold



Violet

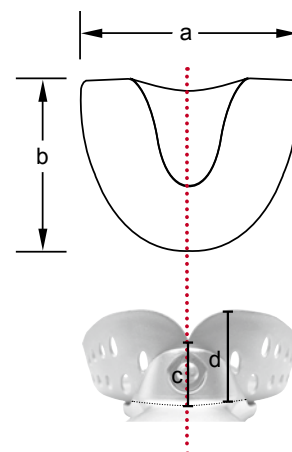

No.	Description	Size (mm)			
		a	b	c	d
19101	Pink	57	48	12	20
19102	Blue	62	54	12	20
19103	Red	68	60	12	22
19104	Gold	75	65	12	22
19105	Violet	84	70	13	22

#### Lower

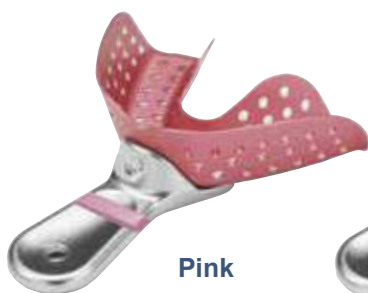

Pink

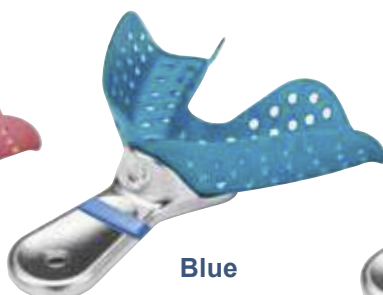

Blue

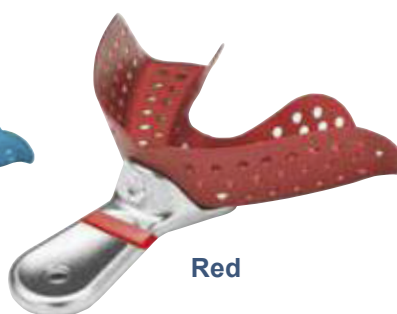

Red

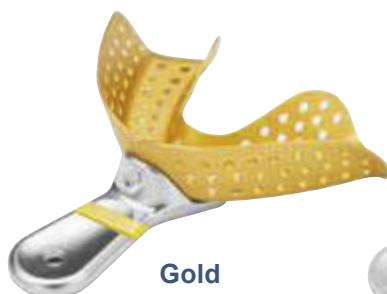

Gold



Violet

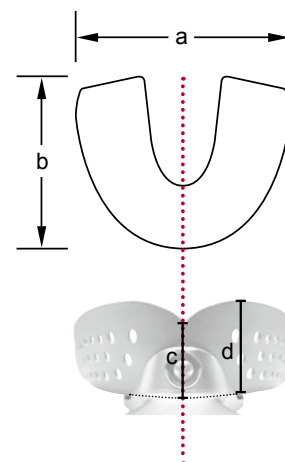

No.	Description	Size (mm)			
		a	b	c	d
19111	Pink	62	44	15	20
19112	Blue	70	48	15	20
19113	Red	75	50	15	20
19114	Gold	82	53	17	22
19115	Violet	88	55	17	22



# Rotating Tray



**\*Stainless Steel**

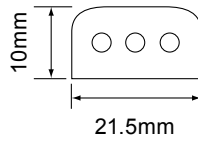

**One Primary Tooth  
No. 19461**

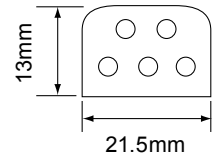

**One Permanent Tooth  
No. 19463**

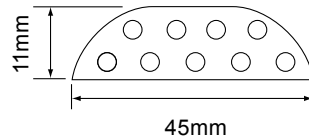

**Local Primary Teeth  
No. 19465**

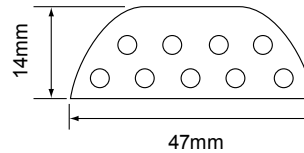

**Local Permanent Teeth  
No. 19467**



# X-Ray Gauge



**Contents** Sleeve / Gauge

**No. 21157**



**Sleeve**



**Gauge**

(1mm by 1mm with hold line every 5mm)

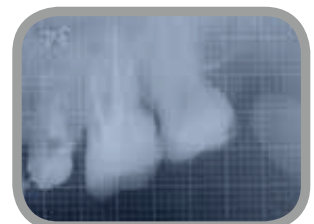

\*Size / W38 x D48 x H8.5mm (Sleeve)  
W33 x D45mm (Gauge)  
\*Material / Si (Sleeve)

\*Suitable for root canal treatment, accurate examination before placing an implant, checking of calculus quantity and its area.

- How to use -





# Color Tape



\*Tape is protected by plastic case with open and close lid for sanitary purpose.

No.	Description
13661	Red
13662	Yellow
13663	Blue
13664	Green
13665	White
13666	Black



\*1 roll / about 3m

\*Width / 3mm

\*Size / W8 x D72 x H44mm

\*Material / Polyester : Deflection temperature 125°C



# Stainless Dish



\*Excellent when using small portion of bath such as topical anesthesia, local disinfection, etching solution, and temporary filling material (powder or liquid).



No. 13670

\*Hole diameter /  $\phi 16\text{mm}$

\*Size / W56 x D31 x H8.5mm



# Injection Cartridge Syringe Type-2



**-Screw-Type-**

**B**  
Conduction Anesthesia  
**No. 14102**





# Pediatric Extracting Forceps Claw

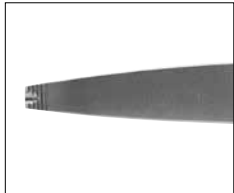

[Actual Size]

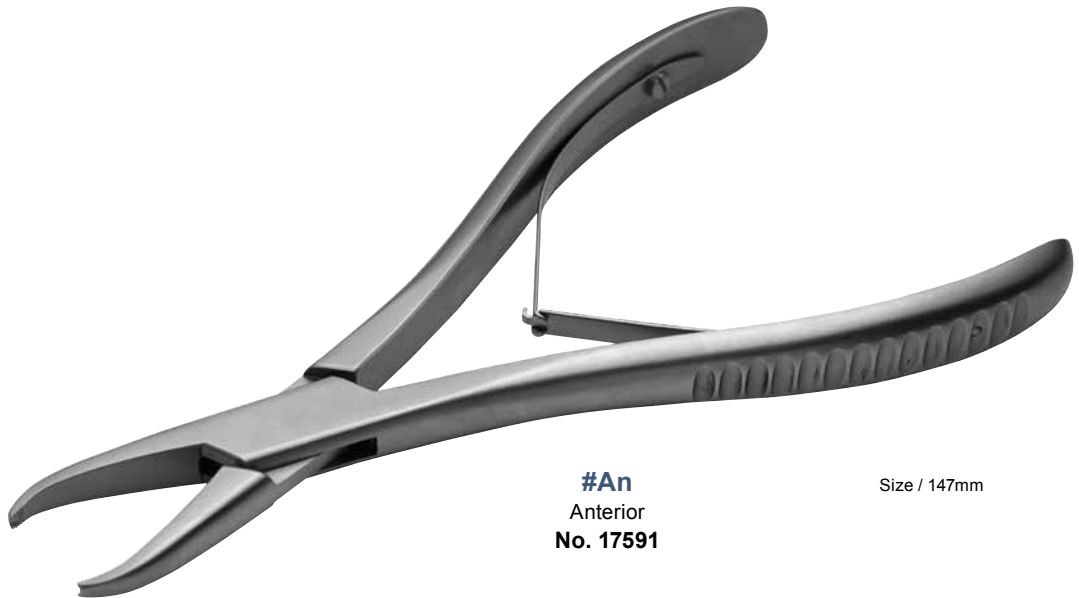

**#An**  
Anterior  
No. 17591

Size / 147mm

How to  
use for  
Anterior



[Actual Size]



**#Po-U**  
Upper posterior  
No. 17592

Size / 146mm

\*Designed to securely hold any condition of deciduous teeth.

\*Ergonomically designed handle offers flexibility and greater tactile sensitivity.



[Actual Size]

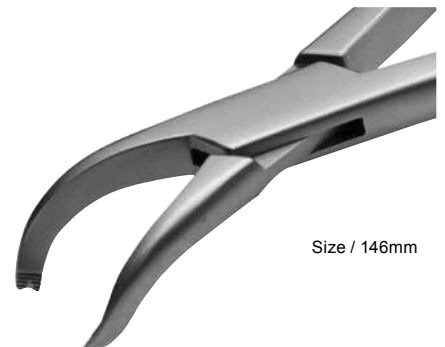

Size / 146mm

How to  
use for  
Posterior



**#Po-L**  
Lower posterior  
No. 17593





## Cement Spatula



No. 11553



## Plaster Spatula Type-3



No. 11704



with Opener  
No. 11705

\*Material / ABS : Heatproof temperature 80°C(Handle)



## Crown Scissors



#311  
Cvd.  
No. 12311



# Irrigating Syringe



#3ml  
No. 13227



# Inlay Crown Setter Set



**Contents** Main body / Flat rubber (2 ea.) / Rubber with pin (2 ea.) / Driver

\*Prevents lift up of prosthesis by allowing patients to bite on this setter during cementing.

**No. 13230**



\*Material / Si (Green part)

## Individual Parts

No.	Description
13231	Flat Rubber (2 ea.)
13232	Rubber with Pin (2 ea.)

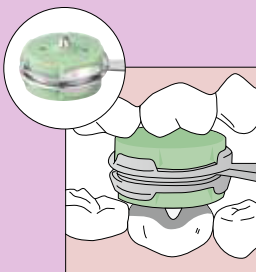

### Inlay setting

\*Wear rubber with pin on one side and flat rubber on the other side.

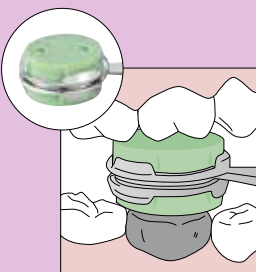

### Crown setting

\*Wear flat rubbers on both sides.





## -B Handle-



### Str.



**#1S**  
Width 4.0mm  
No. 16101



**#2S**  
Width 3.5mm  
No. 16102



**#3S**  
Width 3.0mm  
No. 16103



**#4S**  
Width 2.5mm  
No. 16104



**#5S**  
Width 2.0mm  
No. 16105

### Cvd.



**#1C**  
Width 4.0mm  
No. 16106



**#2C**  
Width 3.5mm  
No. 16107



**#3C**  
Width 3.0mm  
No. 16108



**#4C**  
Width 2.5mm  
No. 16109



**#5C**  
Width 2.0mm  
No. 16110



# Scraper



**YS-706**  
**No.22706**



# Locking Tweezers



**YS-707S**  
**No.22707**

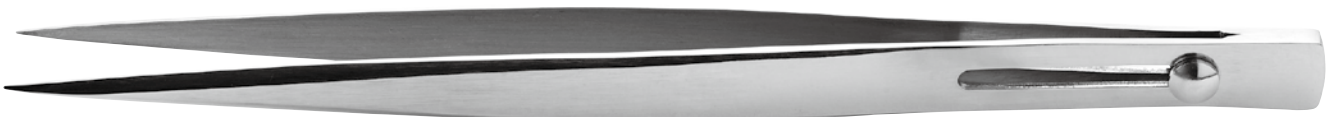

**YS-708L**  
**No.22708**



# Adams Pliers



**Universal T/C**  
**No.22001**



## Convertible Cap Removing Pliers



**No.27934**



- 1) Insert the blade edge parallel to cap from mesial side of buccal tube slot.

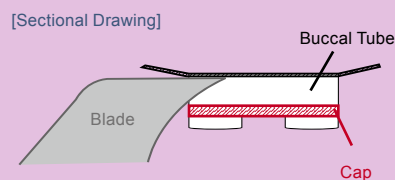

- 2) By gripping the handle, Move the blade to distal side and remove the cap easily.

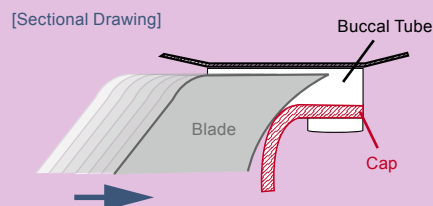

\*Please remove the fallen cap from a mouth.



# Tying Pliers



\*Tie ligature wire on the bracket.



**YS-506**  
**No.22506**

\*Steiner Type.

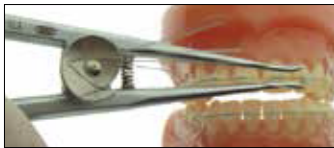

**YS-507**  
**No.22507**

\*Coon Type.

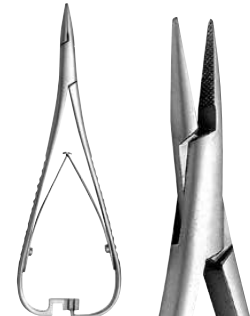
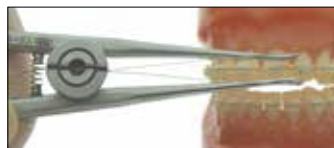

**YS-508**  
**No.22508**

\*Used for applying both long and short type ligature wire.



# Ligature Director



\*Tuck excess ligature wire.

**YS-704**  
**Single End**  
**No.22704**



\*Tie ligature wire on the bracket with wing shape.  
\*With one instrument, two function-tucking and tying.

**YS-704A**  
**Twister**  
**No.22754**



\*Tuck excess ligature wire.

**YS-704B**  
**Double End**  
**No.22755**



# Arch Wire Director



**No.27709**





# Module Pliers



\*Put module on the bracket.

\*With ultra thin tips, easy to insert into the mouth.

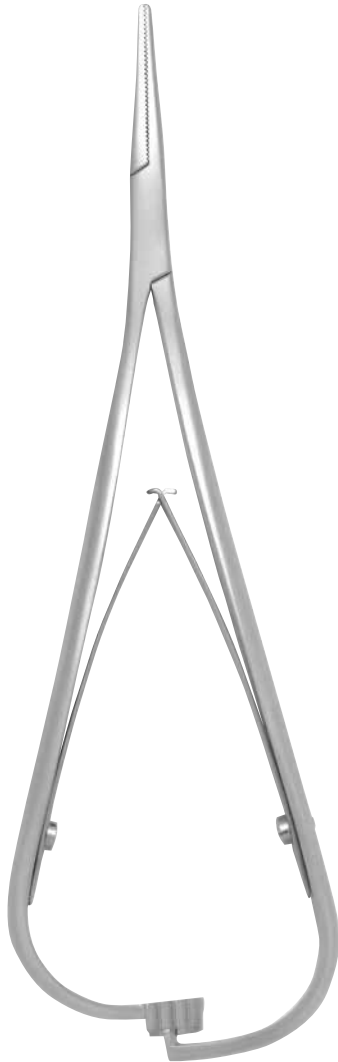

**Str.**  
**No.22509**



**Cvd.**  
**No.22510**

\*For Lingual

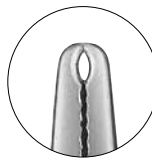

**with Groove Str.**  
**No.22511**



\*With groove, module can move easily and give power on bracket fairly.



**Mosquito Str.**  
**No.22513**



**Mosquito Cvd.**  
**No.22514**





# Separator



\*Before applying band, used for placement of separating elastic.



**YS-551**  
**No.22551**



# Band Seater



\*Set band by patient's own occlusal force.

\*Tip can be replaced.



**YS-703**  
**No.22703**



# Band Pusher



\*Insert band.



**YS-701**  
**No.22753**



# Bracket Tweezers



\*Hold firmly the bracket by groove at the tips.

\*At the end of the handle with measure (3.5mm, 4.0mm, 4.5mm, 5.0mm) helps bracket height and angulation.

**No.22761**



# Articulator



**-for Construction Bite-**

**YS-714**  
**No.22714**



# Ball-Pointed Applicator



**No. 25015**





# Tension Gauge



\*Measure the force of coil spring and elastic.



**YS-31 5N**  
**No.22955**



**YS-31D Dial (5N)**  
**No.22930**

\*1N 100g

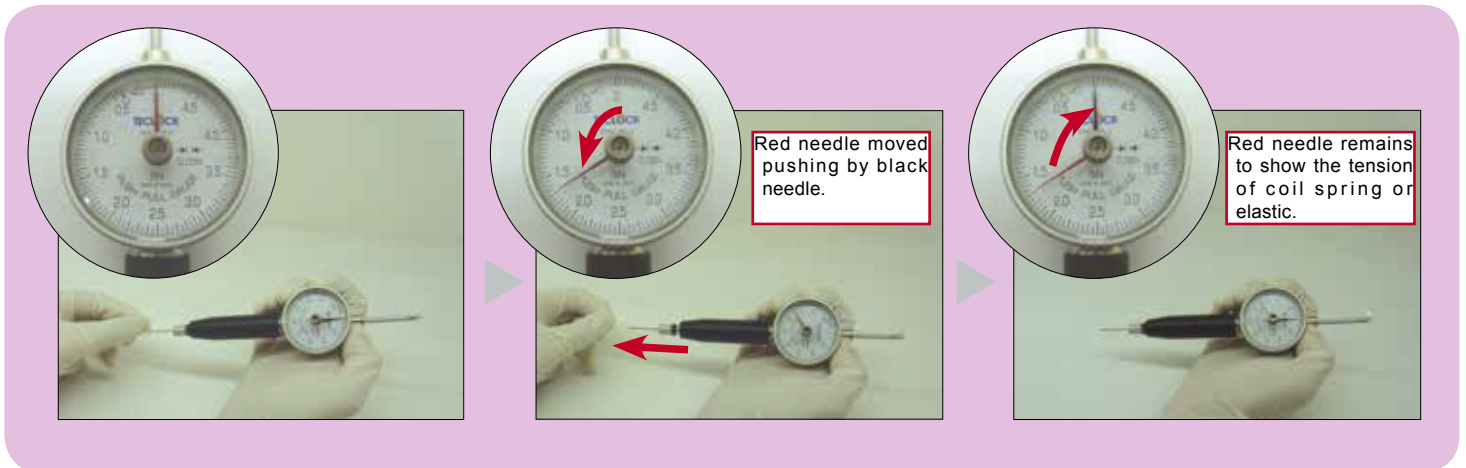

# Orthodontic Calipers

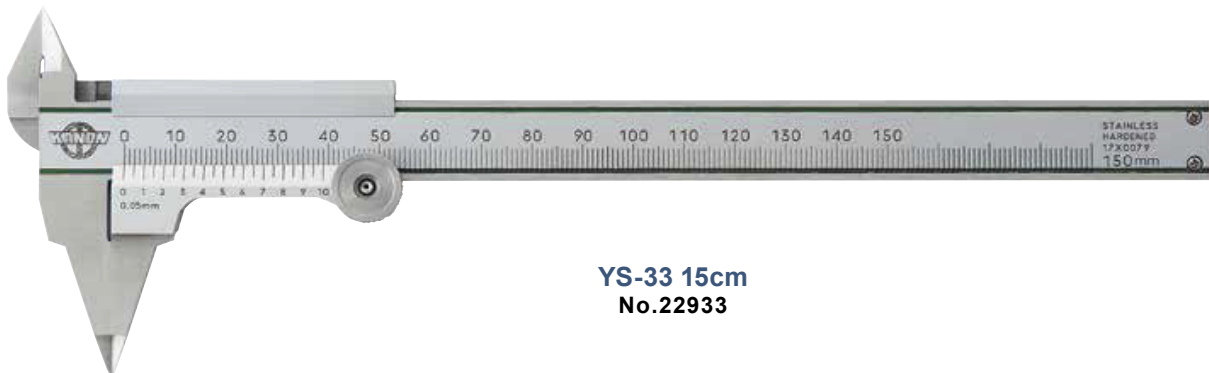

**YS-33 15cm**  
**No.22933**





# Distal End Cutter **EVER**Fine



\*Cut and hold distal end of arch wire.

\*Cemented carbide inserts provide high performance and long life of the tips.

\*Joint part has changed from 3pc(YS) to 2pc(EVER Fine). This change can reduce the problem of rust in joint part.



Size / 124mm

**606S T/C**  
**No.27606**

\*Cut up to ●Round wire .012"-.026"  
■Rect. wire .016"x.016"-.022"x.028"



Size / 147mm

**606L T/C**  
**No.27607**

\*Cut up to ●Round wire .012"-.026"  
■Rect. wire .016"x.016"-.022"x.028"



**YDM**  
(Sharp.3 616L T/C • 606L T/C)



**Company A**

\*With long handle and small head to ensure easy access in hard to reach areas.

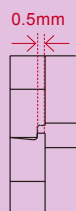

**606S T/C**  
**606L T/C**



# Pin & Ligature Cutter **EVER**



\*Cut excess ligature wire.

\*Hard material inserts ensure cutting of ligature wire and elastic.

\*Joint part has changed from 3pc(YS) to 2pc(EVER Fine). This change can reduce the problem of rust in joint part.



**Classic**

**615**  
**with Hard Material**  
**No.27615**

\*Cut up to .014" (ø0.35mm)



**Fine**

**605**  
**with Hard Material**  
**No.27605**

\*Cut up to .012" (ø0.30mm)

## **Fine**

\*To avoid breakage, insert hard material on the tip.

\*Fine curved shape provide performance to cut ligature wire on crowded area, dislocated area easily.



\*10° angle and fine curve allow easy to access both pre molars and molars.





**Classic** Traditional and classical design fascinate artistic mind.

**Fine** Supple curved handle narrow box joint fascinate new generations.

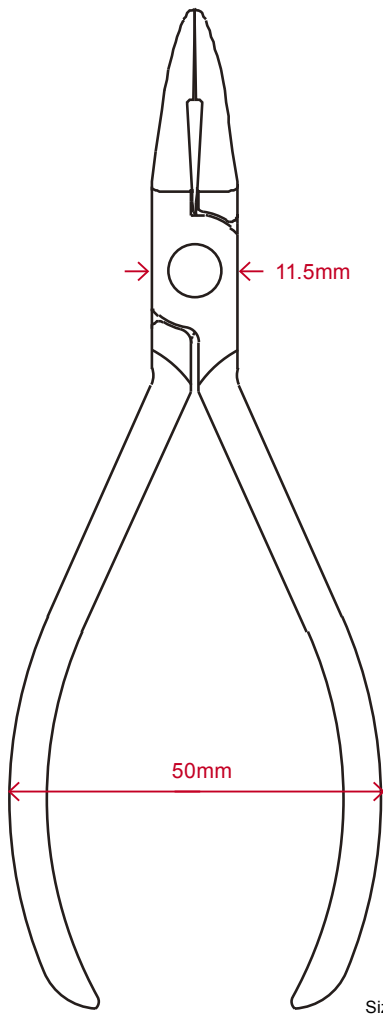

**Classic**

Size / 133mm

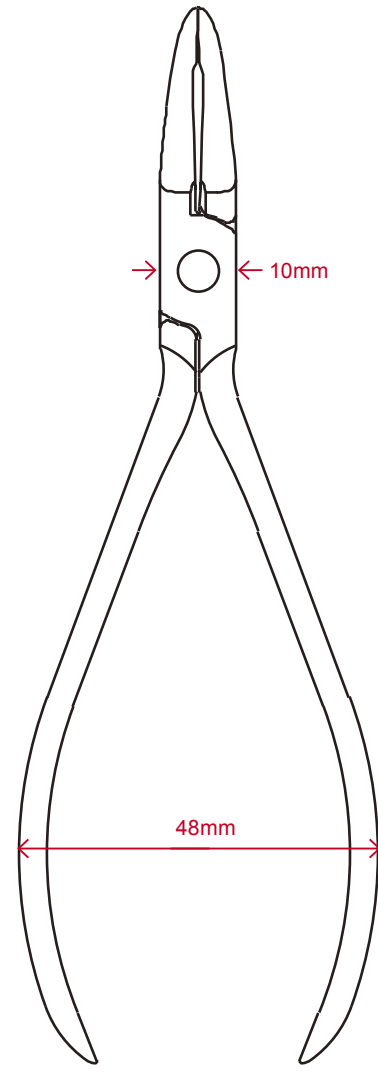

**Fine**

Size / 140mm

## -Utility Pliers-



**Classic**

**420  
How  
No.27420**

\*Insert, remove the main wire.  
\*Bend ligature wire, UA.



**Fine**

**442  
How  
No.27442**



**Classic**

**422  
Utility  
No.27422**

\*Texture of tip is  
0.25mm(.010"),  
can hold arch  
wire firmly.



**Fine**

**440  
Utility  
No.27440**

\*Insert, remove the main wire.  
\*Multi purposes for tying ligature etc.



## -Utility Pliers-



Classic

**421**  
**Weingart**  
No.27421



\*Texture of tip is  
0.25mm(.010"),  
can hold arch  
wire firmly.



Fine

**441**  
**Weingart**  
No.27441



\*Texture of tip is  
0.25mm(.010"),  
can hold arch  
wire firmly.

\*Insert, remove the main wire.  
\*Multi purposes for tying ligature etc.

## -Bending Pliers-



Classic

**415**  
**Tweed Arch**  
No.27415



Fine

**455**  
**Tweed Arch**  
No.27455



\*Maximum wire capacity .022"x.028"

\*Hold arch wire, apply torq, offset-  
bend, inset-bend.

## -Bending Pliers-



Classic

**417**  
**Three Jaw**  
No.27417



Fine

**457**  
**Three Jaw**  
No.27457



\*Maximum wire capacity .036"  
\*Quad Helix, lingual arch, activate  
of main wire.



Classic

**418**  
**Bird Beak**  
No.27418



Fine

**458**  
**Bird Beak**  
No.27458



\*Maximum wire capacity .036"  
\*Bend retainer wire, clasp.



Classic

**414**  
**Young**  
No.27414



Fine

**454**  
**Young**  
No.27454



\*Maximum wire capacity .040"  
\*Bend retainer wire, adjust inner bow  
with three steps. (1.4mm, 3.0mm,  
4.5mm in diameter)



Classic

**416**  
**Tweed Loop Forming**  
No.27416



Fine

**456**  
**Tweed Loop Forming**  
No.27456



\*Maximum wire capacity .022"x.028"  
\*Round beak is shaped 3 layers of  
cylinders (1.25mm, 1.85mm, 2.26mm  
in diameter) can be used for closing  
helical loop, helical loop, omega loop.



\*Traditional and classical design fascinate artistic mind.

\*Matte surface can avoid reflection of pliers under bright light.

## -Bending Pliers-



Classic

419

**Nance Closing Loop**  
No.27419

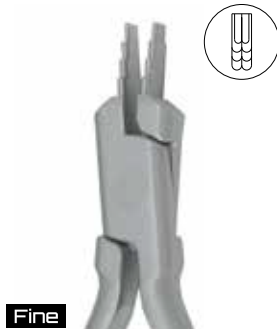

Fine

459

**Nance Closing Loop**  
No.27459

\*Maximum wire capacity .022"

\*With using each step (3.5mm, 4.5mm, 5.5mm, 6.5mm), arrange the loop wire, apply torque on MEAW loop.



With  
Cemented  
Carbide  
insert

Classic

423

**Kim T/C (with Cutter)**  
No.27423



With  
Cemented  
Carbide  
insert

Fine

453

**Kim T/C (with Cutter)**  
No.27453

\*Maximum wire capacity .016"x.022"

\*Cut up to .020"

\*Bend MEAW loop.

## -Bending Pliers-



With  
Cemented  
Carbide  
insert

Classic

424

**Light Wire T/C (with Cutter)**  
No.27424



With  
Cemented  
Carbide  
insert

Fine

452

**Light Wire T/C (with Cutter)**  
No.27452

\*Maximum wire capacity .020"

\*Cut up to .020"

\*Designed for circle hook, tear drop.



Fine

445

**Step 1/2mm**  
No.27445

446  
**Step 3/4mm**  
No.27446

447  
**Step 1mm**  
No.27447

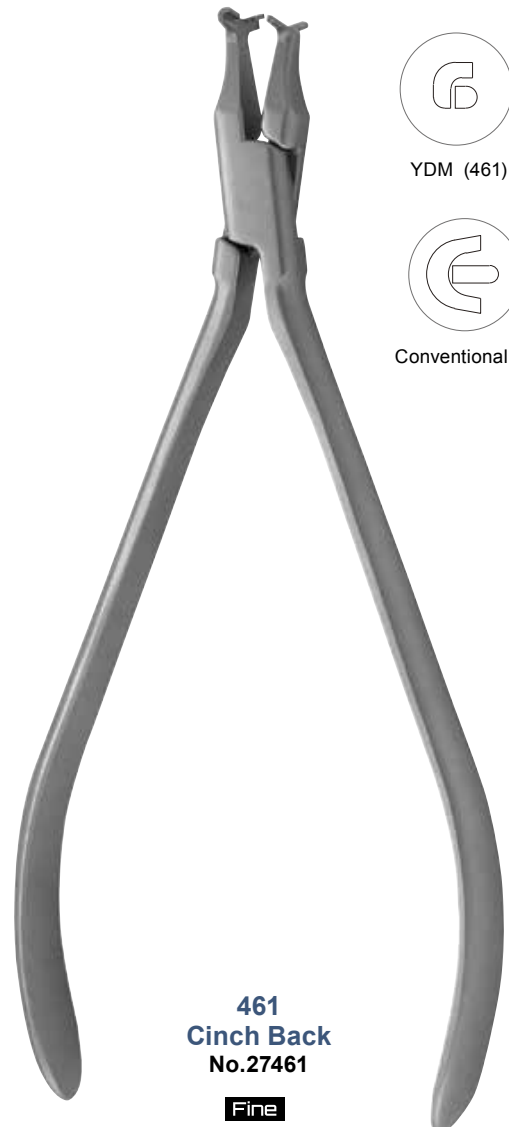

YDM (461)



Conventional Type

461  
**Cinch Back**  
No.27461

Fine



**EVER** SERIES



**EVER** Fine

445 Step 1/2mm  
No.27445

446 Step 3/4mm  
No.27446

447 Step 1mm  
No.27447



YDM unique and efficient design of "Step" and "Cinch Back" Pliers.

**EVER** Fine

461 Cinch Back  
No.27461

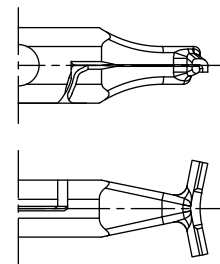
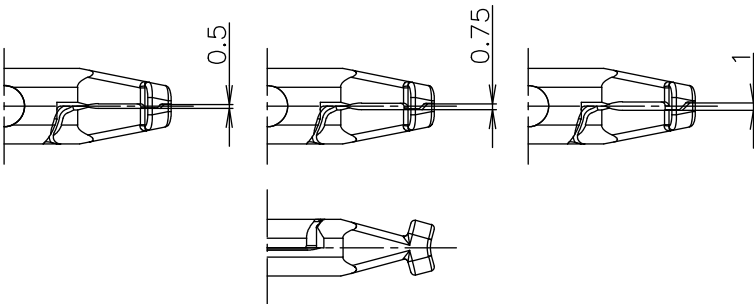

Small head with unique design for "beautifully parallel step".  
3 types, 1mm, 0.75mm and 0.5mm, available.



Stylish hammer head for bending both "up and down with beautiful angle". Up to .020 for easy and smart bending just by this one pliers.





**New**

**EVER** Classic  
428 Torquing F  
No.27428

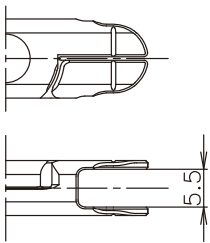

**New**

**EVER** Classic  
427 Torquing M  
No.27427

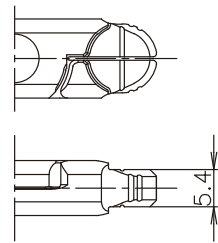

Apply the torque to arch wire with this combination of #27427 and #27428.  
15° and 30° lines for "M" and "F" make your bending smooth and easier.

**New**

**EVER** Classic  
426 Lingual  
Hollow Chop  
No.27426

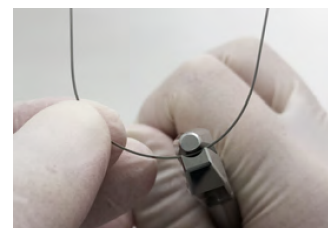
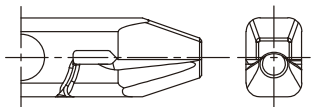

Excellent performance not only for mushroom arch with posterior teeth of lingual wire but also for the narrow curve with  $\beta$ -Ti type material of lingual straight.



Suitable for bending lingual arch and similar materials requiring delicate bending.

"Utility" Hollow Chop Pliers for not only Lingual but also Labial treatment.

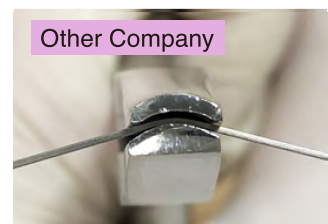
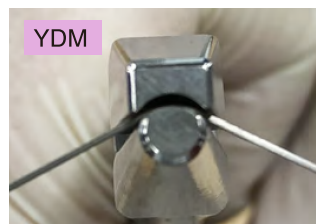

Comparison with conventional product.





## -Banding Pliers-



Classic

**412**  
**Band Removing**  
No.27412



Fine

**443**  
**Band Removing**  
No.27443

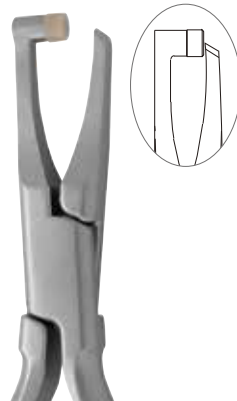

Fine

**460**  
**Band Removing L**  
No.27460



Classic

**410**  
**Band Contouring**  
No.27410

## -Banding Pliers-



Classic

**411**  
**Band Margin**  
No.27411

## -Debonding Pliers-



Classic

**413**  
**Bracket Removing T/C**  
No.27413



Fine

**444**  
**Bracket Removing T/C**  
No.27444

## -Crimping Pliers-



Classic

**425**  
**Crimping**  
No.27425



## -Aligner Pliers-

- \*With fine tips to ensure to insert into lingual or narrow part, crowded teeth.
- \*With long handle to ensure to insert into lingual or narrow part, crowded teeth.
- \*Matte surface can avoid reflection of pliers under bright light.
- \*Supple curved handle fits female dentists.



**448**  
**Tear Drop**  
**No.27448**



**449**  
**Vertical**  
**No.27449**





**450**  
**Horizontal**  
**No.27450**



**451**  
**Hole Punch**  
**No.27451**

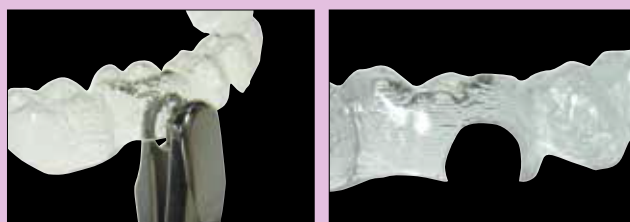
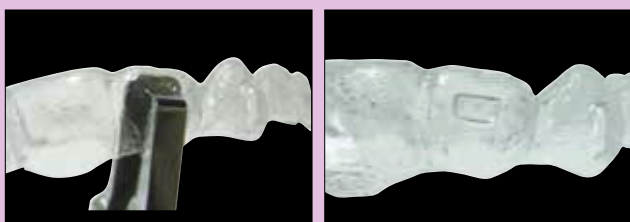



# Laboratory Pliers



\*Easily identified by a color grip.

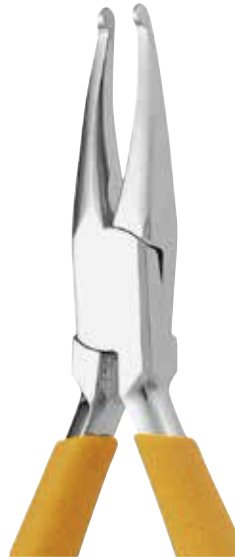

**How #110**  
**No. 18410**

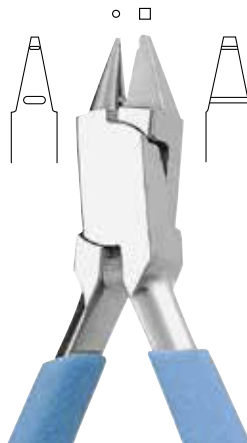

**Clasp Bending #1**  
**No. 18481**



**Gordon #137**  
**No. 18437**



**Three Jaws**  
**No. 18483**

\*Maximum wire capacity /  $\varnothing 1.0\text{mm}$ .



# Wire Cutter



\*Cut retainer wire, clasp wire.



**YS-601**  
**No.22601**

\*Cut up to .032" (ø0.80mm)



**YS-602**  
**KI**  
**No.22602**

\*Cut up to .045" (ø1.10mm)



**YS-603**  
**Standard**  
**No.22603**

\*Cut up to .048" (ø1.20mm)



# Handy Torch



\*Sharp flame is suitable for delicate work.

\*Gas is empty at the time of delivery.

## Ortho No.27907

Size / W76.6xD54.5xH154mm

### Specifications

\*Weight / 245g (with the screen board)

\*Gas Volume / 15g

\*Combustion Time / 80min.

\*Flame Temperature / 1300°C (blue flame)



### Name of parts

