



Orthodontics

Bracket	156
Cutter	159
Orthodontic Pliers	164
Wire Cutter	174
Ligature Instrument	175
Bonding Instrument	178
Orthodontic Articulator	180
Measuring Device	181
Torch	183
Locking Tweezers / Chin Cap	184
Impression Tray	185





6 features of COBY™

ZIRCONIA CERAMIC BRACKETS



1) Excellent Toughness and Flexibility

Great material reduces fracture.

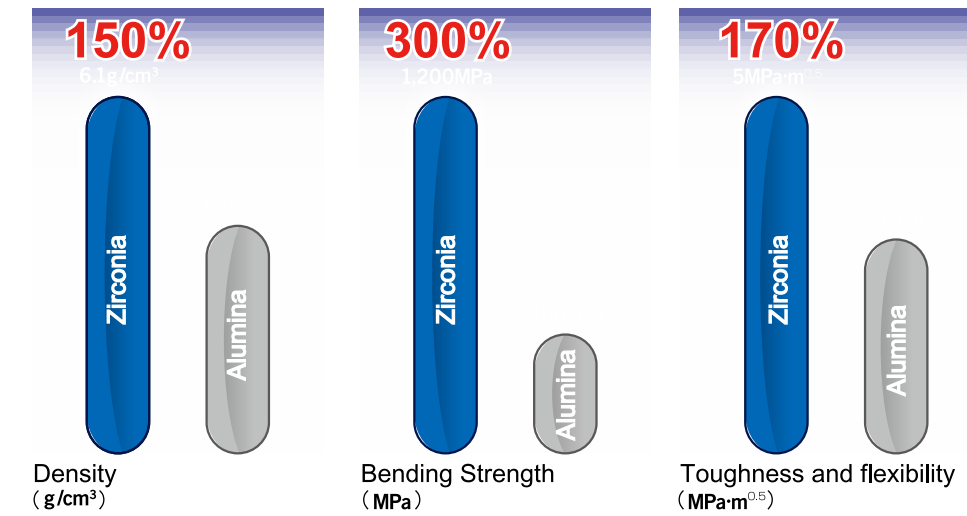

2) Low Profile

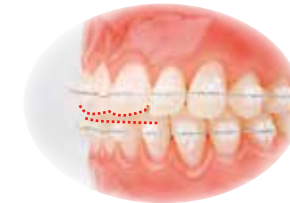

Zirconia Ceramic provides low profile, compact shape, which reduces occlusal interference.

3) Shoulder System

Shoulder



At initial stage, it provides speedy treatment, and middle and late stage, it provides positive torque control.

Comparing to Composite and Alumina



Initial Stage

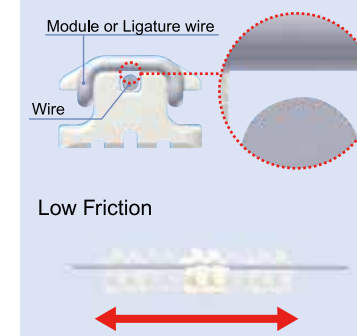

Middle and Late Stage

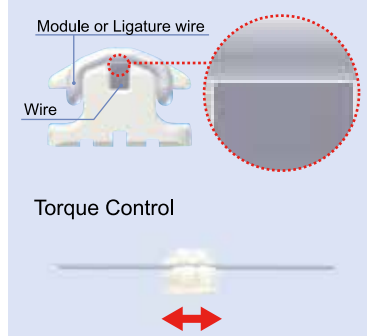

4) Bonding Base

Suitable for any kind of adhesion bond.

Light Cure OK
Chemical Cure OK

Central Base

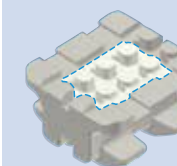

Maximum retentive force exercises in the central undercut part.

Outside Base



Outside base designed into shallow undercut for smooth debonding.

5) Safety Debonding



Approach points for debonding instrument on mesial / distal corners of base provide smooth and safe debonding without breakage of bracket.

Smooth Debonding

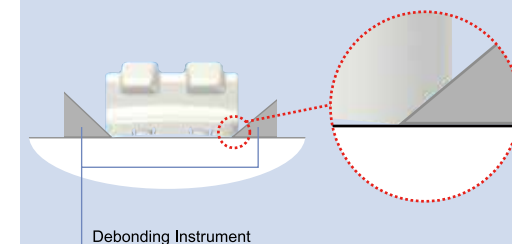

6) Aesthetics

Similar to natural teeth.

Color





Zirconia Ceramic Bracket COBY

-Straight .018" slot-

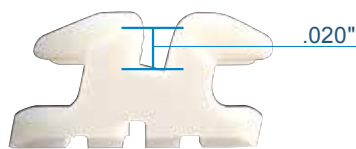

-Wire Selection for .018" slot.-

[.018" x .025" Slots]

Low friction

Round wire .012" / .014" / .016" / .018"

Rect. wire .016" x .016"

Torque control

Rect. wire .016" x .022"

.017" x .025"

.018" x .025"

	Code No.	Description	Tooth
1 Case kit	27880	STR-018-3-3	$\frac{3+3}{3+3}$
	27881	STR-018-3-3H ※	
	27884	STR-018-5-5	$\frac{5+5}{5+5}$
	27885	STR-018-5-5H ※	

※ Only UL3 : With the hook.

	No.	Description	Tooth	Color Marking	Torq.	Ang.
Upper (10 ea.)	27800	STR-U1R-018	$\frac{1}{1}$	●	12	5
	27801	STR-U1L-018	$\frac{1}{1}$	●	12	5
	27802	STR-U2R-018	$\frac{2}{2}$	●	8	9
	27803	STR-U2L-018	$\frac{2}{2}$	●	8	9
	27804	STR-U3R-018	$\frac{3}{3}$	●	-2	11
	27805	STR-U3L-018	$\frac{3}{3}$	●	-2	11
	27806	STR-U3R-018H	$\frac{3}{3}$	●	-2	11
	27807	STR-U3L-018H	$\frac{3}{3}$	●	-2	11
Lower (10 ea.)	27808	STR-U45-018	$\frac{54}{45}$	●	-7	0
	27811	STR-L12-018	$\frac{21}{12}$	-	0	0
	27813	STR-L3R-018	$\frac{3}{3}$	●	-11	7
	27814	STR-L3L-018	$\frac{3}{3}$	●	-11	7
	27815	STR-L3R-018H	$\frac{3}{3}$	●	-11	7
	27816	STR-L3L-018H	$\frac{3}{3}$	●	-11	7
	27817	STR-L4-018	$\frac{4}{4}$	●	-17	0
	27820	STR-L5-018	$\frac{5}{5}$	●	-22	0

-Straight .022" slot-

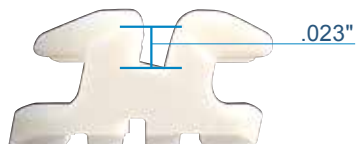

-Wire Selection for .022" slot.-

[.022" x .028" Slots]

Low friction

Round wire .012" / .014" / .016" / .018" / .020"

Rect. wire .016" x .022"

Torque control

Rect. wire .017" x .025"

.018" x .025"

.019" x .025"

.021" x .025"

.022" x .028"

	Code No.	Description	Tooth
1 Case kit	27882	STR-022-3-3	$\frac{3+3}{3+3}$
	27883	STR-022-3-3H ※	
	27886	STR-022-5-5	$\frac{5+5}{5+5}$
	27887	STR-022-5-5H ※	

※ Only UL3 : With the hook.

	No.	Description	Tooth	Color Marking	Torq.	Ang.
Upper (10 ea.)	27840	STR-U1R-022	$\frac{1}{1}$	●	12	5
	27841	STR-U1L-022	$\frac{1}{1}$	●	12	5
	27842	STR-U2R-022	$\frac{2}{2}$	●	8	9
	27843	STR-U2L-022	$\frac{2}{2}$	●	8	9
	27844	STR-U3R-022	$\frac{3}{3}$	●	-2	11
	27845	STR-U3L-022	$\frac{3}{3}$	●	-2	11
	27846	STR-U3R-022H	$\frac{3}{3}$	●	-2	11
	27847	STR-U3L-022H	$\frac{3}{3}$	●	-2	11
Lower (10 ea.)	27848	STR-U45-022	$\frac{54}{45}$	●	-7	0
	27851	STR-L12-022	$\frac{21}{12}$	-	0	0
	27853	STR-L3R-022	$\frac{3}{3}$	●	-11	7
	27854	STR-L3L-022	$\frac{3}{3}$	●	-11	7
	27855	STR-L3R-022H	$\frac{3}{3}$	●	-11	7
	27856	STR-L3L-022H	$\frac{3}{3}$	●	-11	7
	27857	STR-L4-022	$\frac{4}{4}$	●	-17	0
	27860	STR-L5-022	$\frac{5}{5}$	●	-22	0

-Standard .018" slot-

-Wire Selection for .018" slot.-

[.018" x .025" Slots]

Low friction

Round wire .012" / .014" / .016" / .018"

Rect. wire .016" x .016"

Torque control

Rect. wire .016" x .022"

.017" x .025"

.018" x .025"

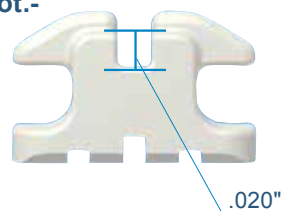

	No.	Description	Tooth	Color Marking	Torq.	Ang.
Upper & Lower (10 ea.)	27870	STD-U1-018	$\frac{1}{1}$	-	0	0
	27871	STD-U2-018	$\frac{2}{2}$	-	0	0
	27872	STD-345-018	$\frac{543}{345}$	-	0	0
	27873	STD-L12-018	$\frac{21}{12}$	-	0	0
1 Case Kit	27890	STD-018-3-3	$\frac{3+3}{3+3}$	-	-	-
	27892	STD-018-5-5	$\frac{5+5}{5+5}$	-	-	-

EVERFine

EVERClassic

Traditional
and
Classical Design.

Fine Tips
and
Supple Curved Handle.



Ever with You...

THE BEST PARTNER OF DENTISTS



SINCE 1948

*Cut and hold distal end of arch wire.

*Cemented carbide inserts provide high performance and long life of the tips.



606S T/C
No.27606

*Cut up to

●Round wire .012"- .020"

■Rect. wire .016"x.016"- .022"x.028"

Size / 124mm



606L T/C
No.27607

*Cut up to

●Round wire .012"- .020"

■Rect. wire .016"x.016"- .022"x.028"

Size / 147mm



YDM
(606L T/C)



Company A
 *With long handle and small head to ensure easy access in hard to reach areas.

*Cut excess ligature wire.

*Hard material inserts ensure cutting of ligature wire and elastic.



615
with Hard Material
No.27615

*Cut up to .014" (ø0.35mm)

Classic



605
with Hard Material
No.27605

*Cut up to .012" (ø0.30mm)

Fine

Fine

*To avoid breakage, insert hard material on the tip.

*Fine curved shape provide performance to cut ligature wire on crowded area, dislocated area easily.



*10° angle and fine curve allow easy to access both premolars and molars.





Pin & Ligature Cutter **EVER**Fine



*Cut excess ligature wire.

*Hard material inserts ensure cutting of ligature wire and elastic.



601
Angle 40
No.27601

*Cut up to .012" (ø0.30mm)



602
Reverse 40
No.27602

*Cut up to .012" (ø0.30mm)



603
Angle 50
No.27603

*Cut up to .012" (ø0.30mm)



604
Reverse 50
No.27604

*Cut up to .012" (ø0.30mm)



*Comparison of, Straight Type and Angled Type.





Orthodontic Pliers **EVER**



- Classic** Traditional and classical design fascinate artistic mind.
- Fine** Supple curved handle narrow box joint fascinate new generations.

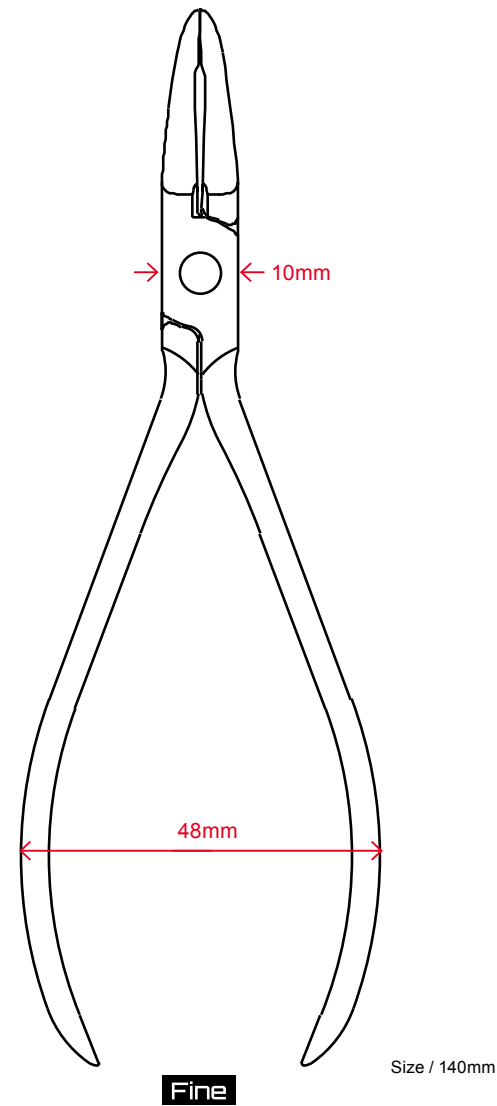
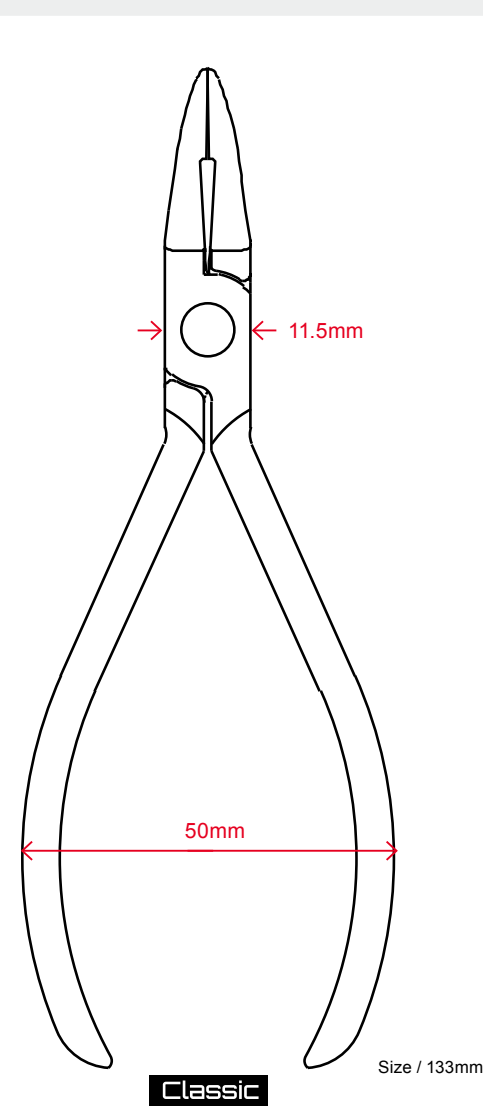

-Utility Pliers-



*Texture of tip is 0.25mm(.010"), can hold arch wire firmly.



*Texture of tip is 0.25mm(.010"), can hold arch wire firmly.

- *Insert, remove the main wire.
- *Multi purposes for tying ligature etc.

*Tips Pictures of 422 / 440 / 462.



**462
Lingual Utility
No.27462**



*Comfortable Long handle with precise tip for both Lingual and Labial treatment.

-Utility Pliers-



- *Insert, remove the main wire.
- *Bend ligature wire, UA.



*Texture of tip is 0.25mm(.010"), can hold arch wire firmly.



*Texture of tip is 0.25mm(.010"), can hold arch wire firmly.

- *Insert, remove the main wire.
- *Multi purposes for tying ligature etc.



-Bending Pliers-

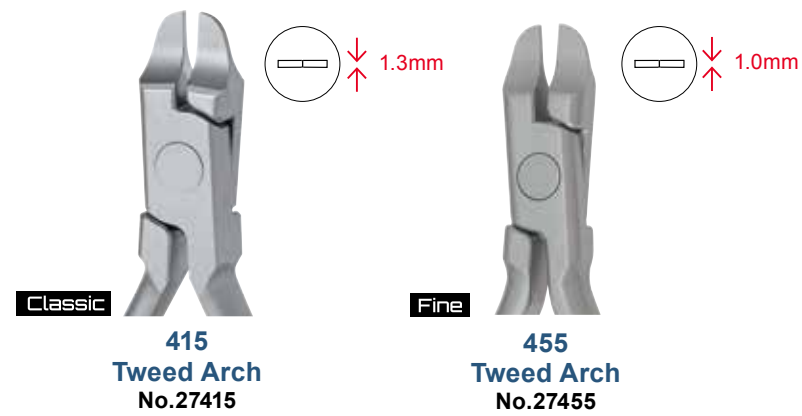

*Maximum wire capacity .022"x.028"
*Hold arch wire, apply torq, offset-bend, inset-bend.

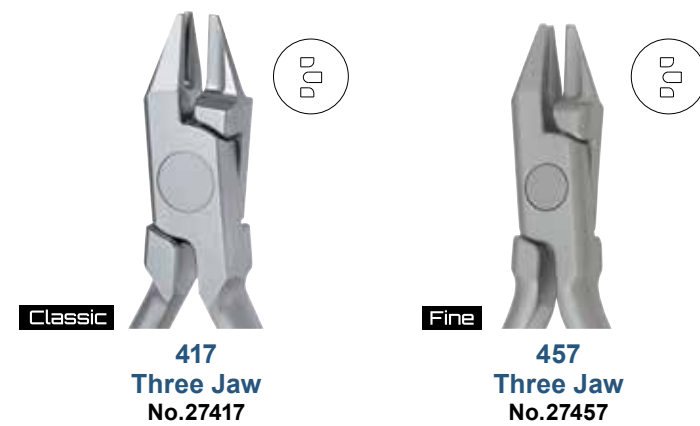

*Maximum wire capacity .036"
*Quad Helix, lingual arch, activate of main wire.



*Maximum wire capacity .040"
*Bend retainer wire, adjust inner bow with three steps. (1.4mm, 3.0mm, 4.5mm in diameter)



*Maximum wire capacity .036"
*Bend retainer wire, clasp.

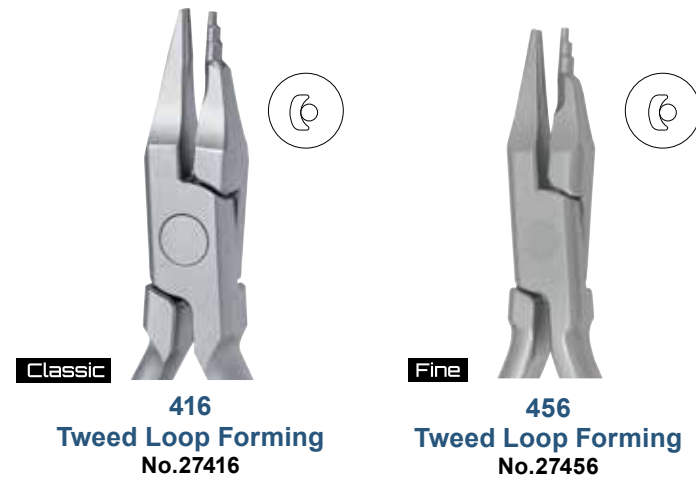

*Maximum wire capacity .022"x.028"
*Round beak is shaped 3 layers of cylinders (1.25mm, 1.85mm, 2.26mm in diameter) can be used for closing helical loop, helical loop, omega loop.

*Traditional and classical design fascinate artistic mind.

*Matte surface can avoid reflection of pliers under bright light.

-Bending Pliers-

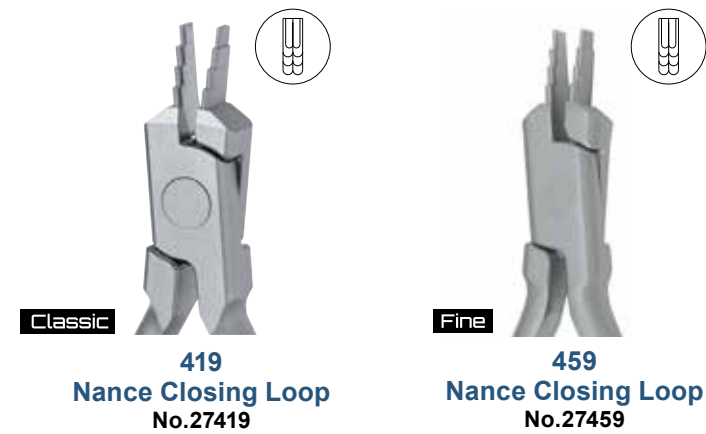

*Maximum wire capacity .022"
* With using each step (3.5mm,4.5mm,5.5mm,6.5mm), make the same height in parallel for loops such as MEAW or Keyhole.

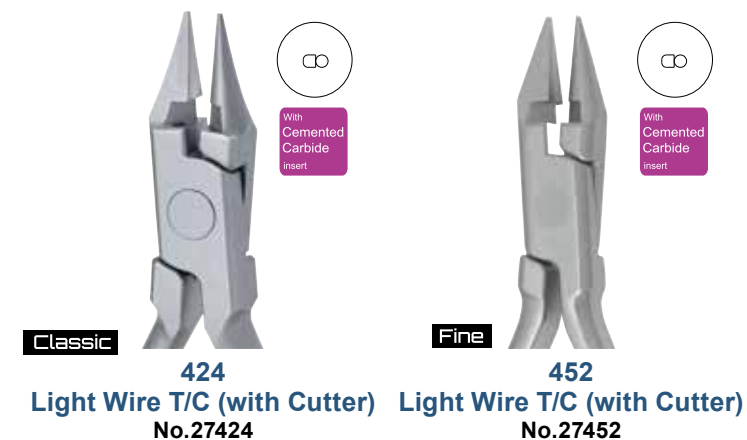

*Maximum wire capacity .020"
*Cut up to .020"
*Designed for circle hook, tear drop.

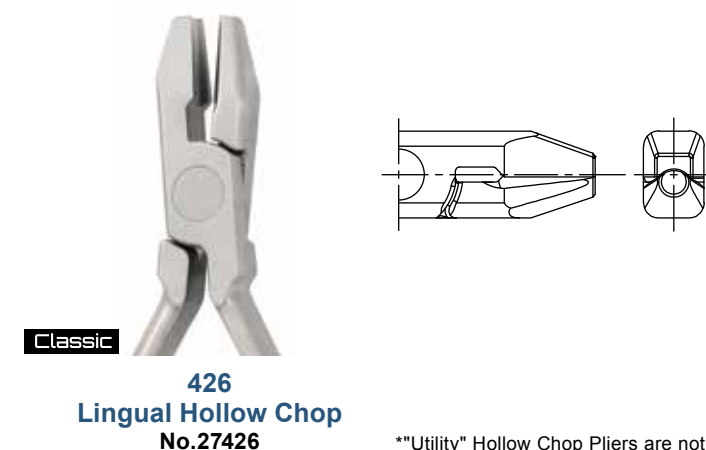

**"Utility" Hollow Chop Pliers are not only for Lingual but also Labial treatment.

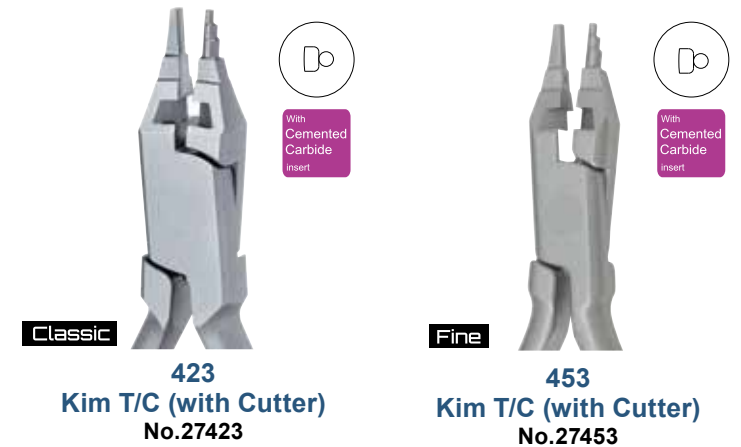

*Maximum wire capacity .016"x.022"
*Cut up to .020"
*Bend MEAW loop.

[Lingual Hollow Chop]

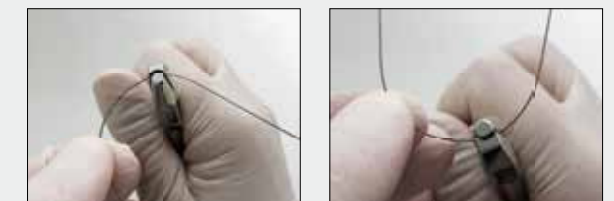

*Excellent performance not only for mushroom arch with posterior teeth of lingual wire but also for the narrow curve with β -Ti type material of lingual straight.



*Suitable for bending lingual arch and similar materials requiring delicate bending.

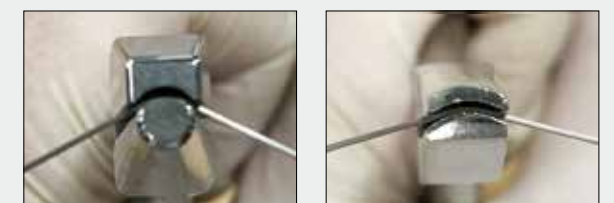

*Comparison with conventional product.



Orthodontic Pliers **EVER**



-Bending Pliers-

*Apply the torque to arch wire with this combination of #27427 and #27428.
*15°and 30°lines for "M" and "F" make your bending smooth and easier.



428
Torquing F
No.27428
Classic

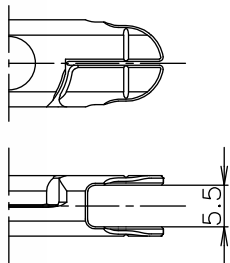

427
Torquing M
No.27427
Classic

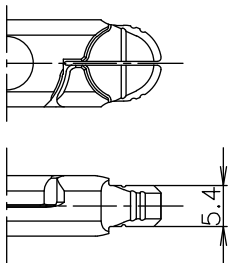

-Bending Pliers-

*YDM unique and efficient design of "Step" and "Cinch Back" Pliers.



445
Step 1/2mm
No.27445
Fine

446
Step 3/4mm
No.27446
Fine

447
Step 1mm
No.27447
Fine

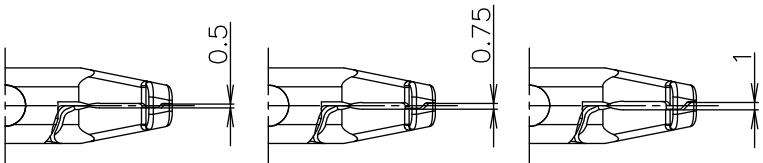

*Small head with unique design for "beautiful parallel step".
*3 types, 1mm, 0.75mm and 0.5mm, available.

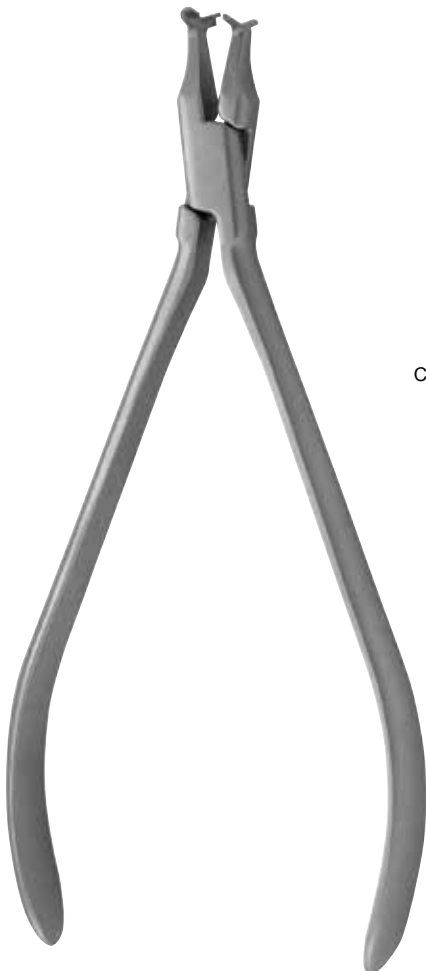

YDM (461)



Conventional Type

461
Cinch Back
No.27461
Fine

*Maximum wire capacity /
Round Wire .020"
Rect Wire .016"x.016"

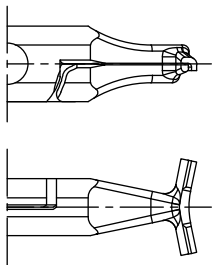

*Stylish hammer head for bending both "up and down with beautiful angle".
*Up to .020 for easy and smart bending just by this one pliers.





-Aligner Pliers-

- *With fine tips to ensure to insert into lingual or narrow part, crowded teeth.
- *With long handle to ensure to insert into lingual or narrow part, crowded teeth.
- *Matte surface can avoid reflection of pliers under bright light.
- *Supple curved handle fits female dentists.



448
Tear Drop
No.27448

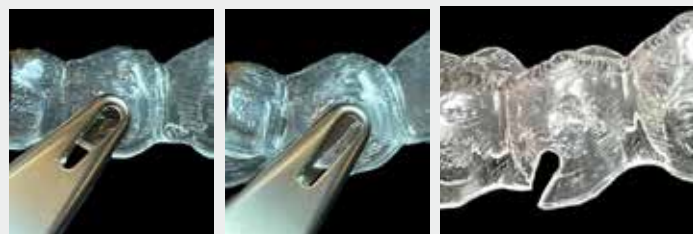

*For making a slit to apply elastic with aligner. Excellently sharp cutting so it doesn't make rough surface, which avoid cutting of elastic.



449
Vertical
No.27449



*For making a vertical hollow to apply torque to mesial or distal part of lingual or buccal side of aligner. Thin and slim shape of tip is designed for easy approach even to narrow incisal margin part, especially lower anterior.



463
Round Former 1.0
No.27463



*For making 1.0mm circle hollow to narrow part of aligner such as lower anterior to apply rotation or torque. Also for making additional hollow to the hollow applied by Vertical or Horizontal pliers for more rotation or torque.



450
Horizontal
No.27450

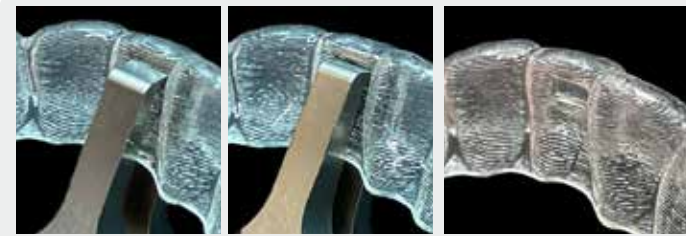

*For making a horizontal hollow to apply rotation to lingual or buccal side of aligner. Thin and slim shape of tip is designed for easy approach even to narrow incisal margin part, especially lower anterior.



464
Round Former 2.0 SM
No.27464



*For making "2.0mm" circle hollow to narrow part of aligner such as lower anterior to apply rotation or torque. Also for making additional hollow to the hollow applied by Vertical or Horizontal pliers for more rotation or torque.



451
Hole Punch
No.27451

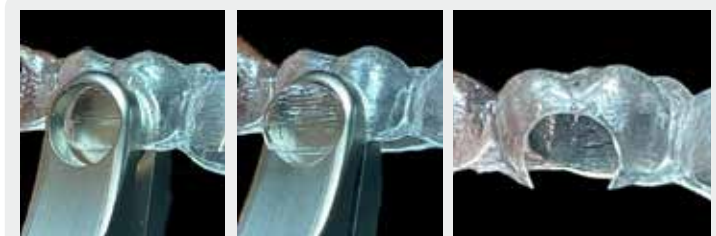

*For making a hole to apply lingual button with aligner. Excellently sharp cutting so it doesn't make rough surface after making a hole. Slim shape of tip is designed for easy approach to the narrow space such as molar part which has low height.



444
Bracket Removing
No.27444

- *For removing "attachment" of aligner efficiently.
- *Please use bur in case attachment remained a little after using this pliers.

-Banding Pliers-

Classic

412

Band Removing

No.27412

Fine

443

Band Removing

No.27443

Fine

460

Band Removing L

No.27460

Classic

410

Band Contouring

No.27410

3.5mm

*Longer tip than 412,443.

-Banding Pliers-

Classic

411

Band Margin

No.27411

Classic

413

Bracket Removing T/C

No.27413

-Debonding Pliers-

Fine

444

Bracket Removing T/C

No.27444

With Cemented Carbide Insert

-Crimping Pliers-

Classic

425

Crimping

No.27425

Adams Pliers

Universal T/C
No.22001



Convertible Cap Removing Pliers

ND-934
No.27934



1) Insert the blade edge parallel to cap from mesial side of buccal tube slot.

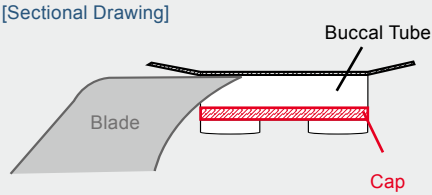
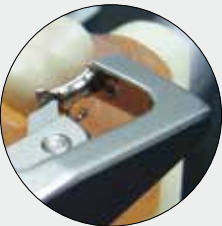

2) By gripping the handle, Move the blade to distal side and remove the cap easily.

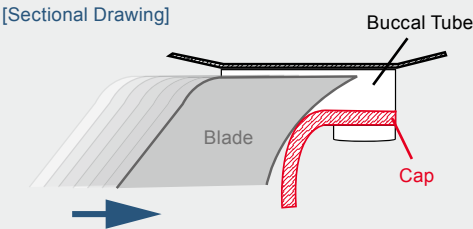

*Please remove the fallen cap from a mouth.

Wire Cutter

*Cut retainer wire, clasp wire.



YS-601
No.22601

*Cut up to .032" (ø0.80mm)

YS-602
KI
No.22602

*Cut up to .045" (ø1.10mm)

YS-603
Standard
No.22603

*Cut up to .048" (ø1.20mm)

Tying Pliers

*Tie ligature wire on the bracket.

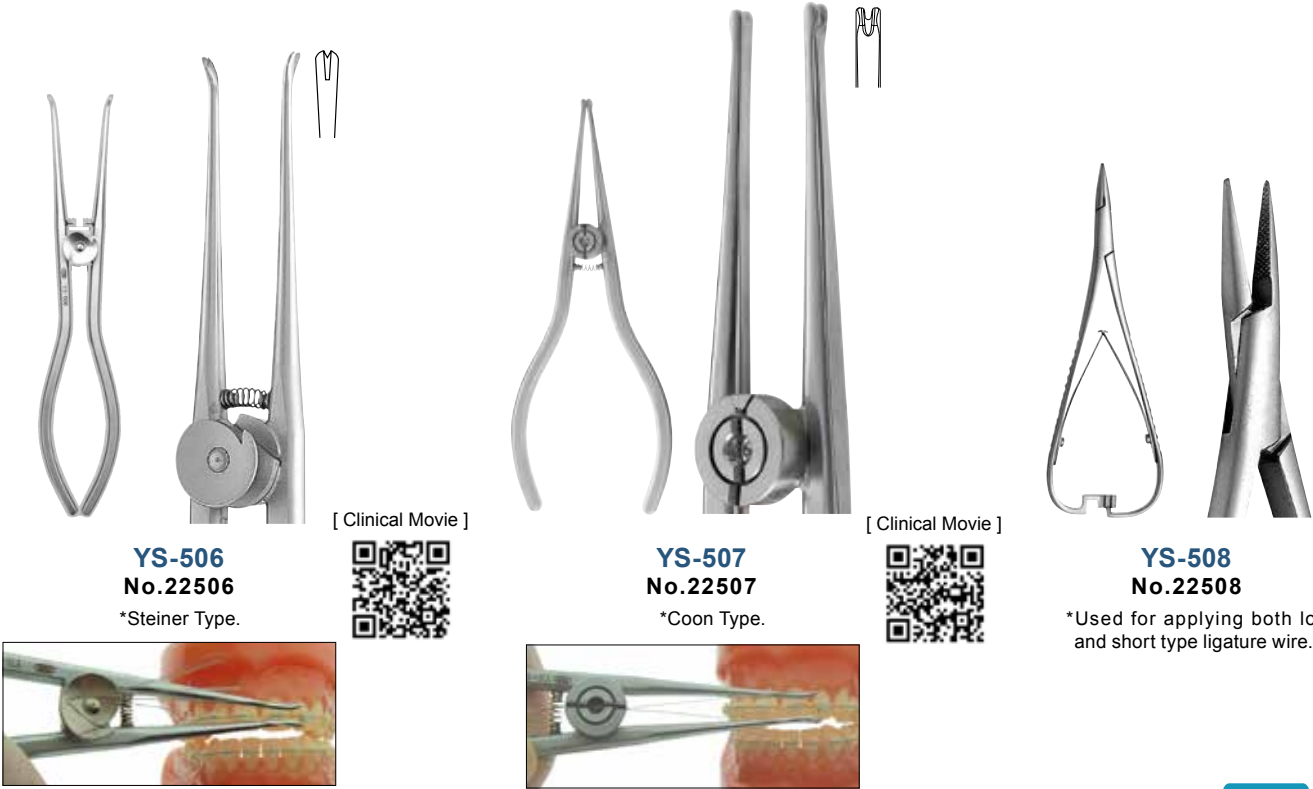

Ligature Director

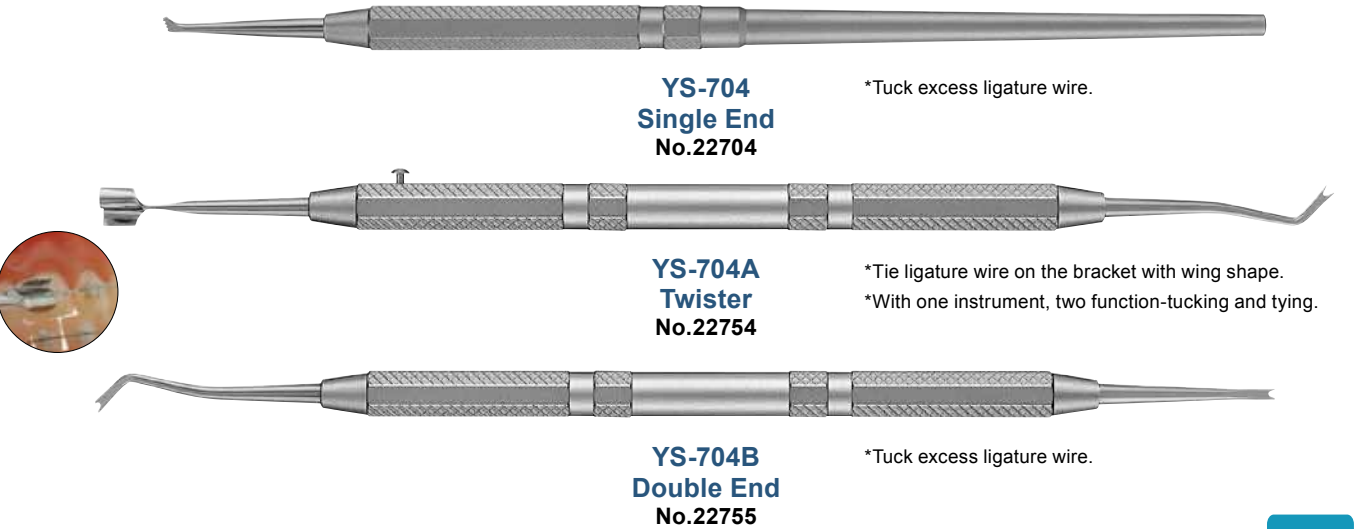

Arch Wire Director

No.27709



*Put module on the bracket.
*With ultra thin tips, easy to insert into the mouth.



Str.
No.22509



Cvd.
No.22510

*For Lingual



with Groove Str.
No.22511



*With groove, module can move easily and give power on bracket fairly.

Mosquito Str. ST
No.29101



Mosquito Cvd. ST
No.29102



Pliers Stand

*Convenient pliers stand made by high-class stainless steel for steriliation and storage of pliers / cutters.
**"S" and "L" size are available.



No.	Description	Size (mm)		
		a	b	c
27400	Pliers Stand S	112	64	80
27401	Pliers Stand L	154	124	140



*Average pliers number.

Orthodontics

Autoclavable up to 135°C

Band Seater

*Set band by patient's own occlusal force.

*Tip can be replaced.



YS-703
No.22703

Band Pusher

*Insert band.



YS-701
No.22753

Surplus Cement Remover

*Remove surplus bonding material smoothly.

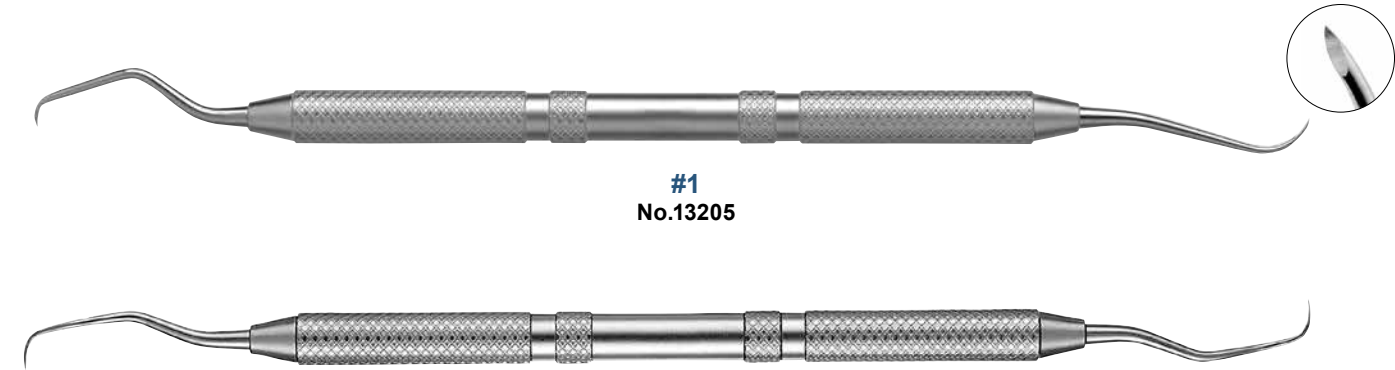

#1
No.13205

#2 for Posterior
No.13206

Bracket Tweezers

*Hold firmly the bracket by groove at the tips.
*At the end of the handle with measure (3.5mm, 4.0mm, 4.5mm, 5.0mm) helps bracket height and angulation.

No.22761



Multi Use Tweezers Fine

**"Multi" use for handling bracket, tube, lingual button and so on.
*Firm and stable hold without dropping off even used for tube thanks to its "exquisite" tip design.
*Designed slim tip not to get stuck with the space of hook part of tube.

No.27409

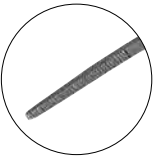

*Serrated tip for stable hold.



*Designed angle for clear view.

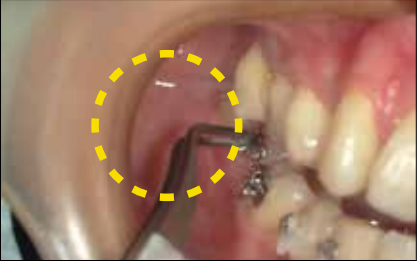

*Bonding tube on second molar.
Designed tip angle not to contact retractor.

*Compact design even for lingual treatment..



*Able to use for holding and tying elastic tube.



-for Construction Bite-

YS-714
No.22714



YS-802A
No.22822



*Product does not include wax form and teeth.

-Example of Practicing with the Typodont Practice Model-



1) Attach the ORT various Wax Form to the Typodont Ocluder by applying molten wax with an instrument.



2) Remove the jaws with the black base as pictured.



3) Dip the jaws into 55-60°C warm water.



4) Lift the jaws from the warm water and dip into cool water. Observe the result.

Model Measuring Device

Contents Main body, Chart (25 sheets)

YS-34 with Chart
No.22934

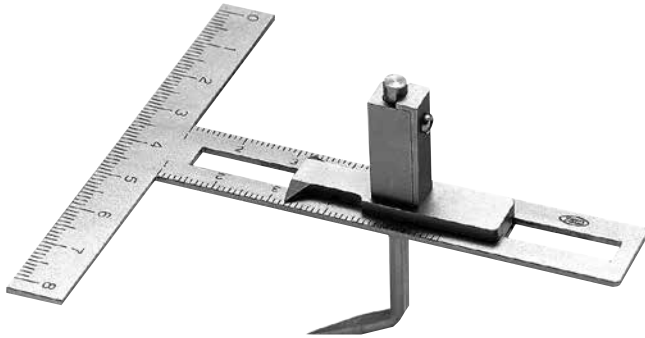

*This measuring device is for the purpose of measuring following length/ Width below on a tooth model, constituting T shape ruler and (vertical, horizontal) indicator needle. The indicator needle designed to slide on its vertical surface.

*This measuring device is designed to measure following (1),(2),(3).
For the measurement of (4) please use separately sold Orthodontic Caliper as the direction mentioned below.

- (1) Length of dental arch
- (2) Width of dental arch
- (3) Length of BASAL ARCH
- (4) Width of BASAL ARCH

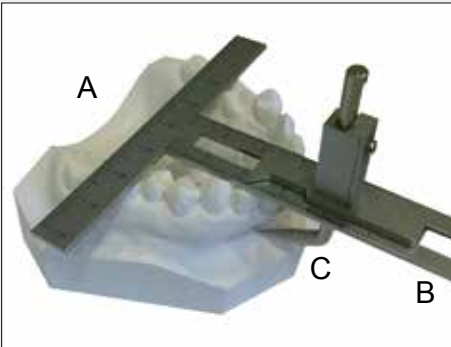

[Direction of how to use]

- A.Horizontal part
- B.Vertical part
- C.Indicator needle

Standard deviation table for width of dental crown, dental arch, BASAL ARCH is also available.

- 1) Width of dental arch
With horizontal part A measure its distance between buccal sides of first premolar tooth.
- 2) Length of dental arch
Fitting in its base line of horizontal part A to the point of first molar teeth in distal part. Then measure the distance to incisal edge of a central incisor with vertical part B.
- 3) Length of BASAL ARCH
Setting horizontal part A as above picture indicates, slide the indicator needle C to fit in the bottom point of the root of a central incisor tooth.
- 4) Width of BASAL ARCH
Measure the bottom point of the root of first premolar tooth with Orthodontic Calipers.

Tension Gauge

*Measure the force of coil spring and elastic.



YS-31 5N
No.22955



YS-31D Dial (5N)
No.22930

*1N ≒ 100g

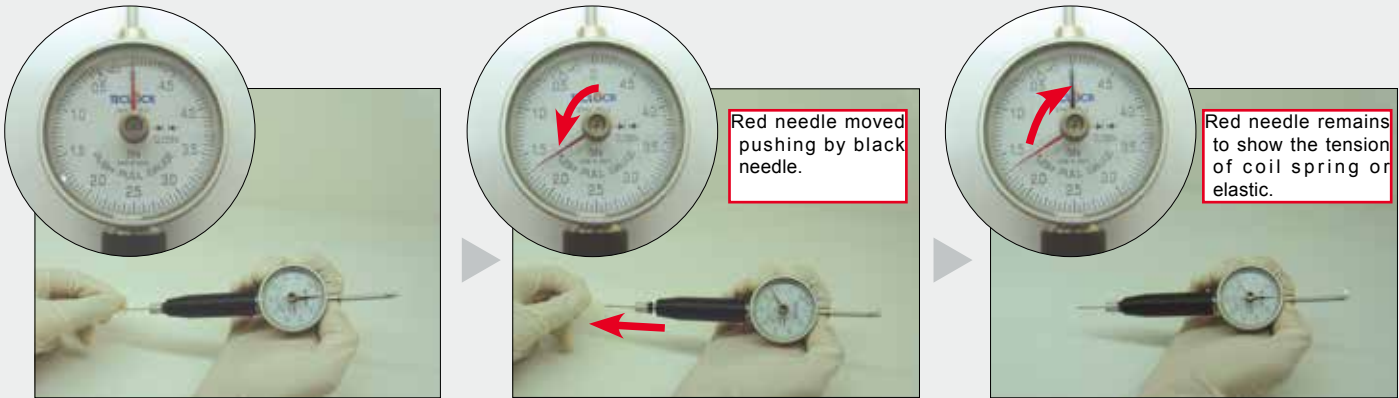

Orthodontic Calipers

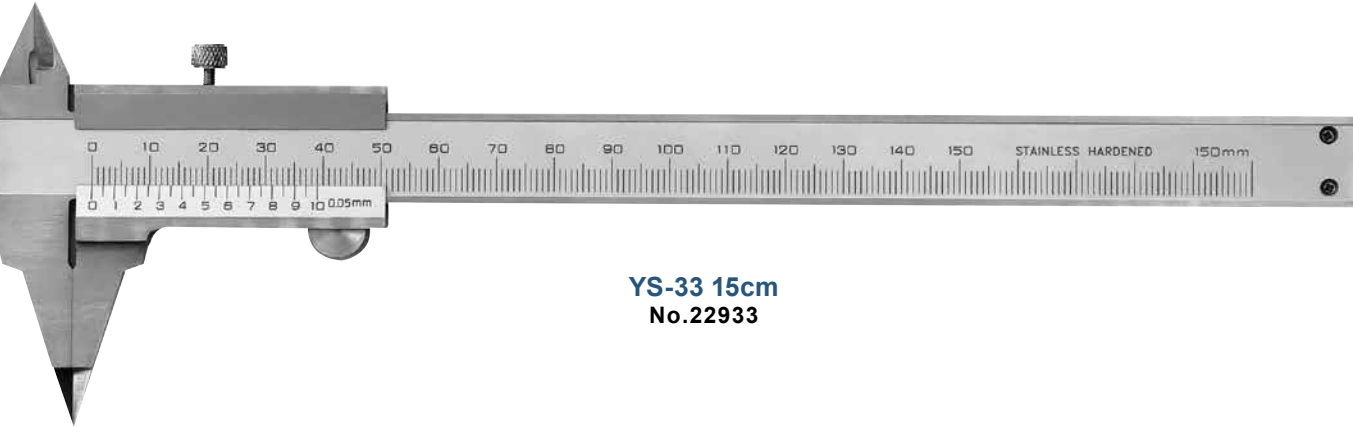

YS-33 15cm
No.22933



Boone Gauge

*Check position of bracket on tooth.
*Measure bracket height 4.5mm, 4.0mm and 3.5mm.



YS-39
No.22939



Handy Torch

*Sharp flame is suitable for delicate work.
*Gas is empty at the time of delivery.



Ortho
No.27907

Size / W76.6xD54.5xH154mm

Name of parts



*The head is given 70° angle to avoid direct dripping of wax on the nozzle when used lying down on the table.

Specifications

- *Weight / 245g (with the screen board)
- *Gas Volume / 15g
- *Combustion Time / 80min.
- *Flame Temperature / 1300°C (blue flame)



YS-706
No.22706



Locking Tweezers



YS-707S
No.22707



YS-708L
No.22708



Chin Cap



No.22868



Maxillary Traction
No.22869



Tracing Plate

YS-40
No.22940

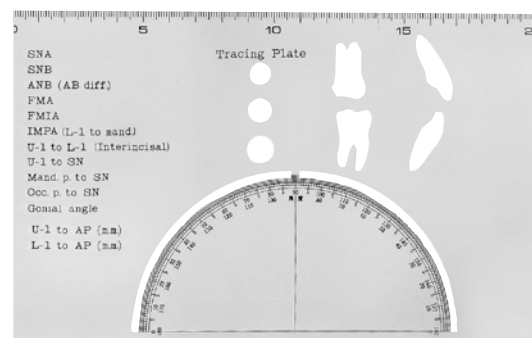

Size / W210xD130mm

Color Tray



-Premium-

*Aluminium

*Color coated for easy identification.

*By an edge with height, the impression of a frenum or buccal mucous membrane can be taken firmly.

*Easily bendable for a custom fit.

*Impression materials stick to alminium well because of features of alminium itself,also they are difficult to be removed when in fitting.

Upper



Pink

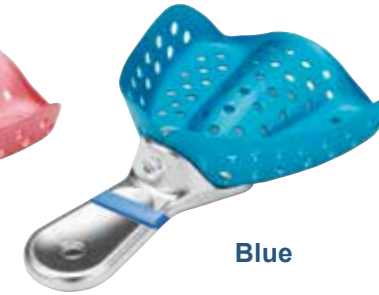

Blue

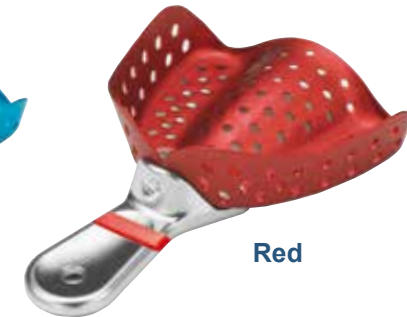

Red



Gold



Violet

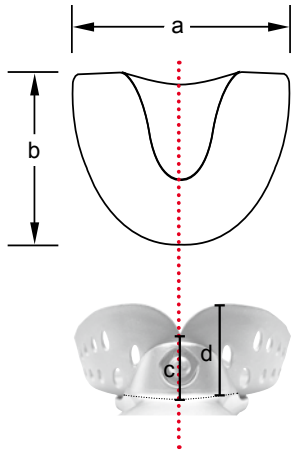

No.	Description	Size (mm)			
		a	b	c	d
19101	Pink	57	48	12	20
19102	Blue	62	54	12	20
19103	Red	68	60	12	22
19104	Gold	75	65	12	22
19105	Violet	84	70	13	22

Lower



Pink

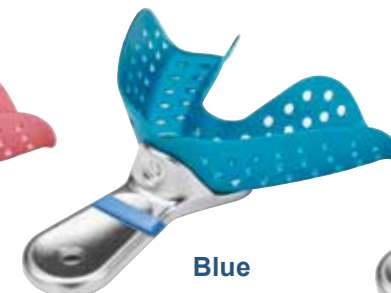

Blue

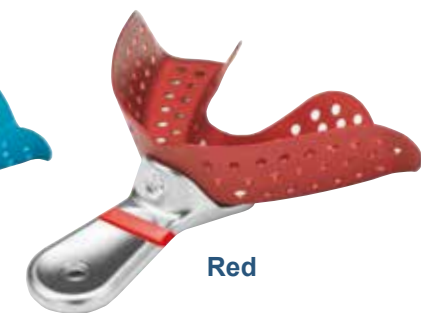

Red

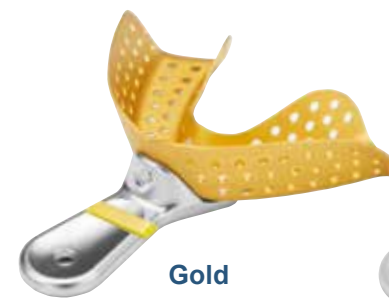

Gold



Violet

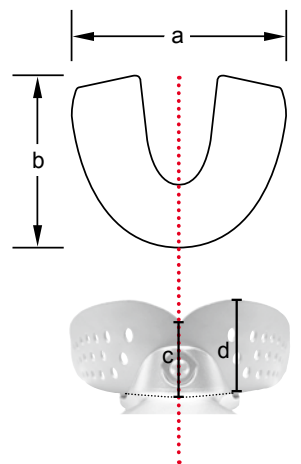

No.	Description	Size (mm)			
		a	b	c	d
19111	Pink	62	44	15	20
19112	Blue	70	48	15	20
19113	Red	75	50	15	20
19114	Gold	82	53	17	22
19115	Violet	88	55	17	22

